

Strainers and Sight Glasses

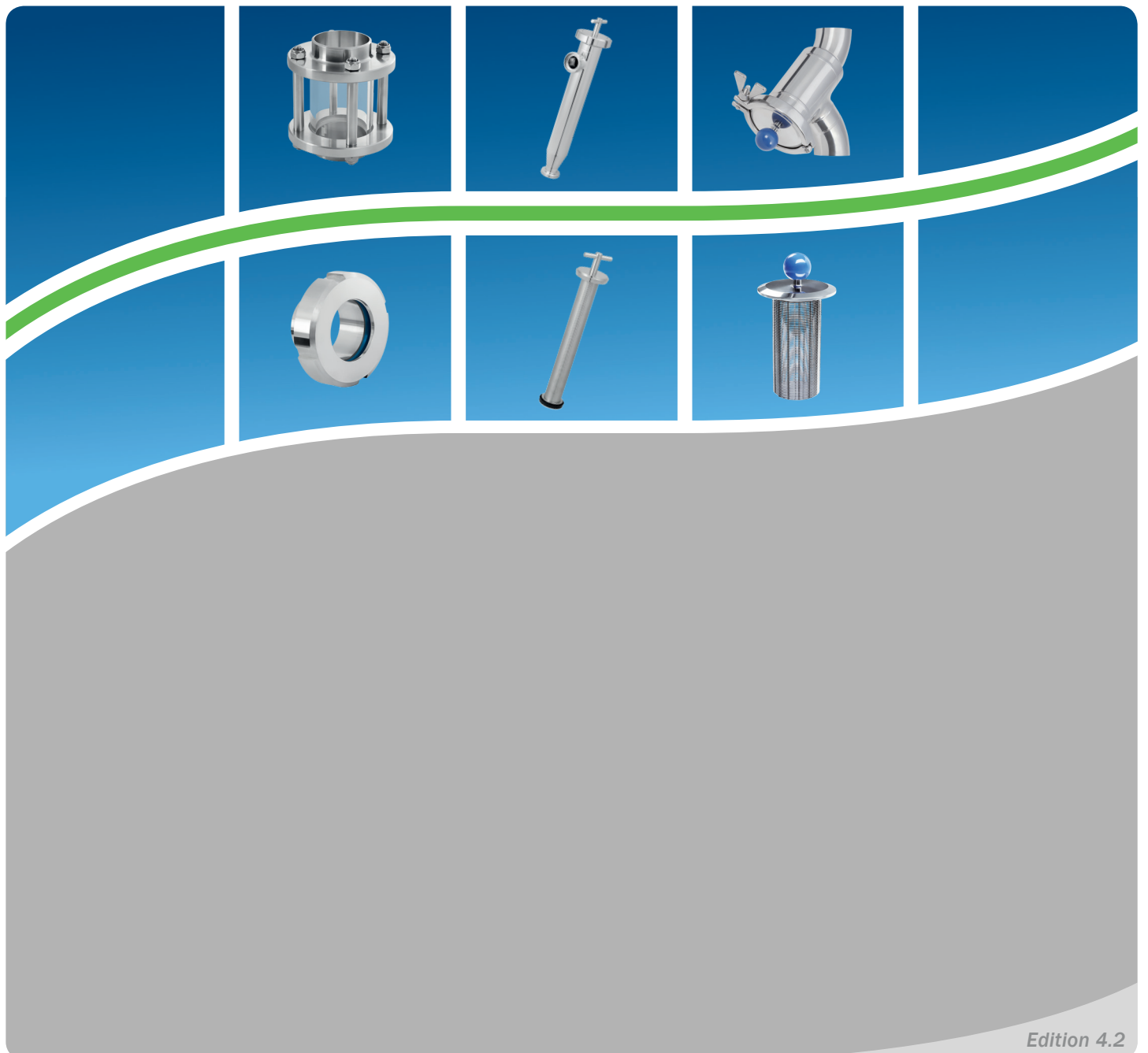
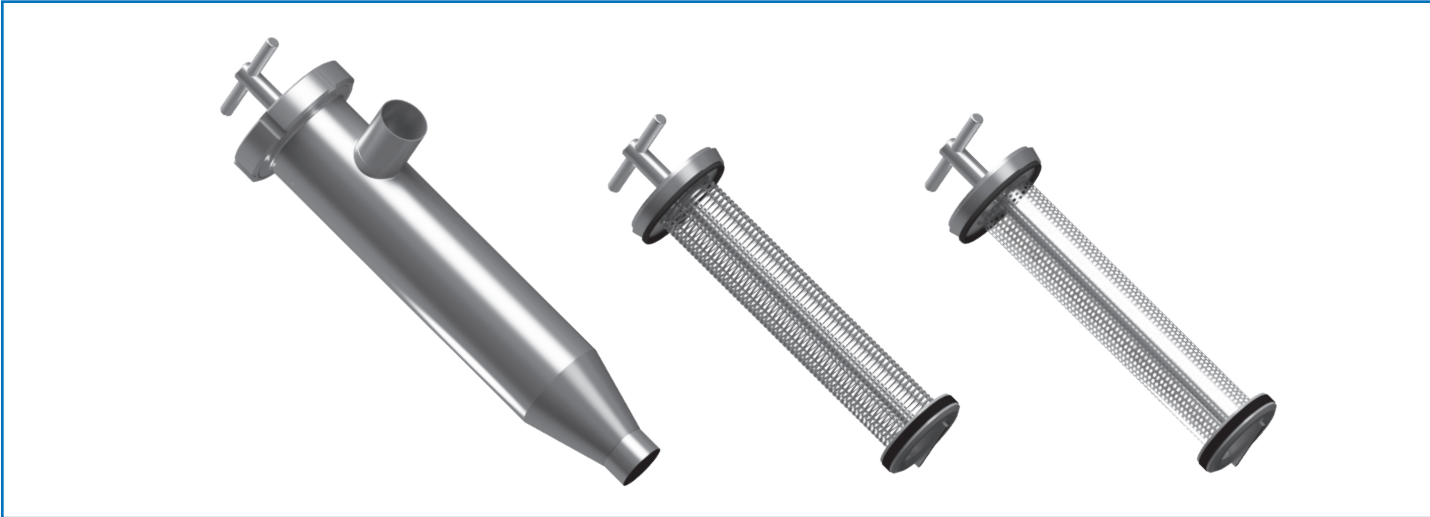

Table of Contents

	Seite
Angle Type Strainers and Accessories	4
Dirt Traps and Accessories	14
Inline Sight Glasses and Accessories	18
Sight Glasses and Accessories	26
Level Indicator	34

* Asterisk in the price column means: on request

Angle Type Strainers and Accessories



As one of the most important system components, AWH strainers protect plants and production machines from mechanical damage, keep undesirable particles away from your product and help to prevent production downtimes. AWH strainers are easy to install, have minimal space requirements, and can be used flexibly due to the large number of different filter inserts.

Technical Parameter

Material:	in contact with the product: 1.4301 (304) /1.4307 (304L), 1.4404 (316L) not in contact with the product: 1.4301 (304) /1.4307 (304L) strainer: 1.4404 (316L)
Surface:	inside: $Ra \leq 0.8 \mu\text{m}$ (strainer and welding seam higher) outside: electro polished
Sealing:	grooved ring, seal ring: EPDM (other materials on request)
Compressive strength:	nominal pressure DN25 - DN100: PN10 nominal pressure DN125 - DN150: PN6
Connections:	standard: welding ends DIN EN 10357 alternative: male ends DIN 11851/SMS alternative: liner ends DIN 11851 alternative: clamp ends DIN 32676 (other variants on request)

Features

1. The gap width and perforation can be easily adjusted to specific requirements by replacing the strainer insert.
2. To carry out maintenance and cleaning work, simply loosen the nut. Strainer inserts can then be pulled out without any problems.
3. During disassembly of the strainer insert, the gap between the tube and the casing is automatically cleaned by the scraper ring.
The slotted tube used has the same dimensions, but features a larger strainer area than conventional perforated sheets.
4. Direction of flow is from the outside to the inside.
5. Determination of the nominal pressure is made on the basis of fluids from Group 1 and for gases from Group 2.
6. Cost-effective production was another important factor in designing this product. Compare us to our competitors. Our prices will impress you.

Not all versions could be included in this catalogue.

Further strainer inserts are available.

We will be happy to tailor our angle type strainer to meet your needs. For example, with heating.

Angle Type Strainers and Accessories

Explosion View

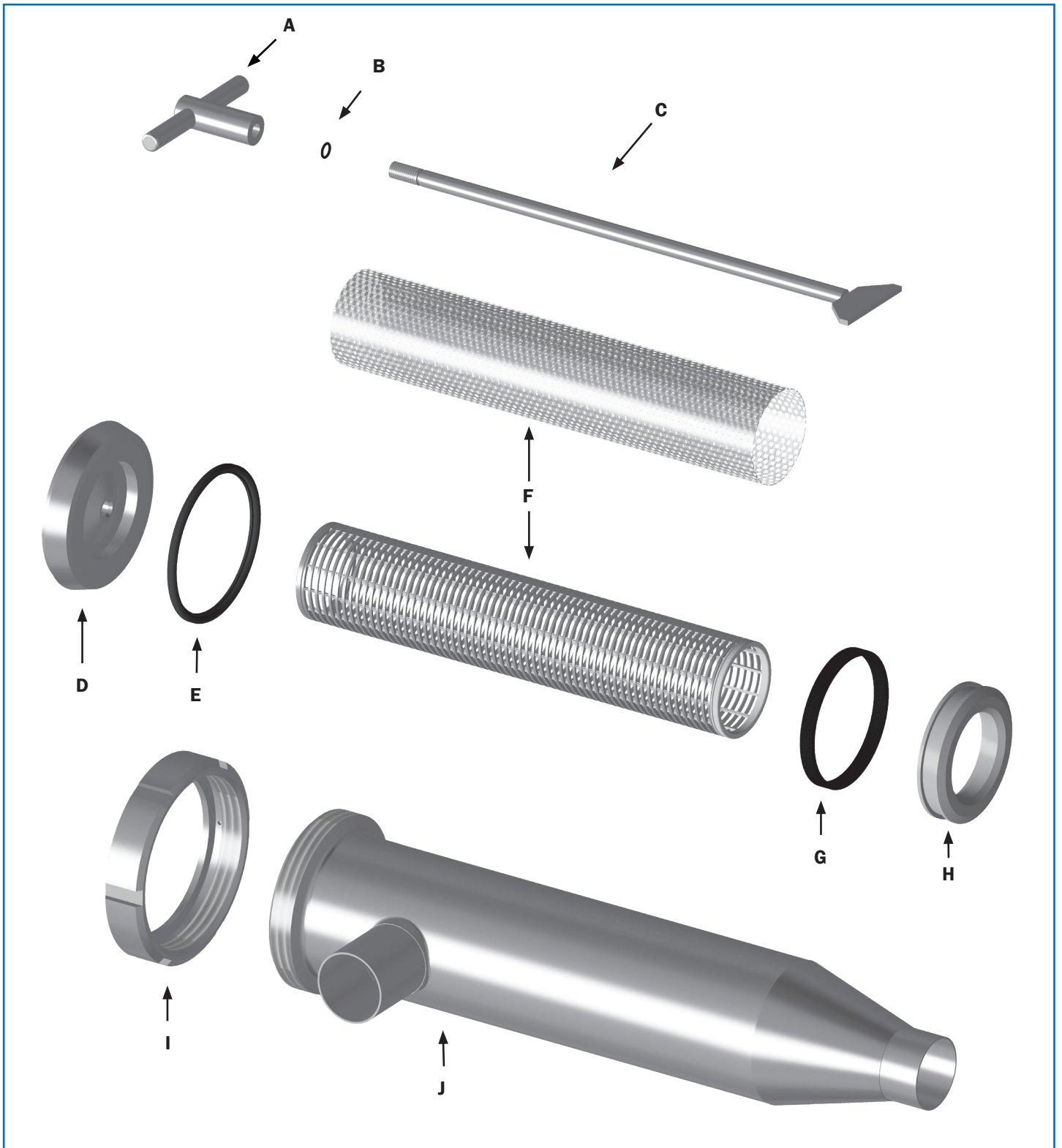

- | | |
|-------------------------|--------------------------|
| A Locking handle | F Strainer insert |
| B Seal ring | G Grooved ring |
| C Tie rod | H Scraper ring |
| D Cap | I Nut |
| E Seal ring | J Casing |

Angle Type Strainers and Accessories

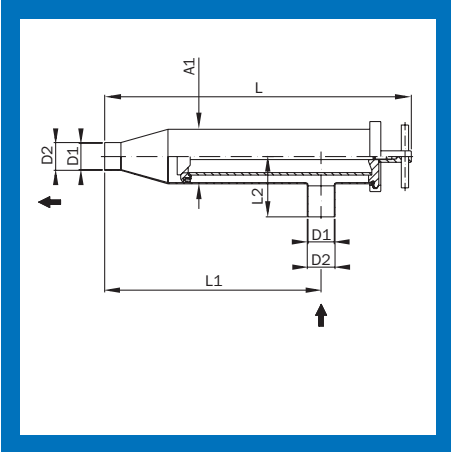

Angle Type Strainer Weld/Weld DIN

DN DIN	D1	D2	D3	H1	L	L1	Weight [kg]
25	26	29	70	82	549	408	4,1
32	32	35	70	77	544	403	4,1
40	38	41	70	85	529	388	4,1
50	50	53	104	113	587	414	7,4
65	66	70	104	113	558	385	7,4
80	81	85	154	150	774	565	16,8
100	100	104	154	167	728	519	16,8
125	125	129	204	160	926	651	33,0
150	150	154	204	164	926	651	28,9

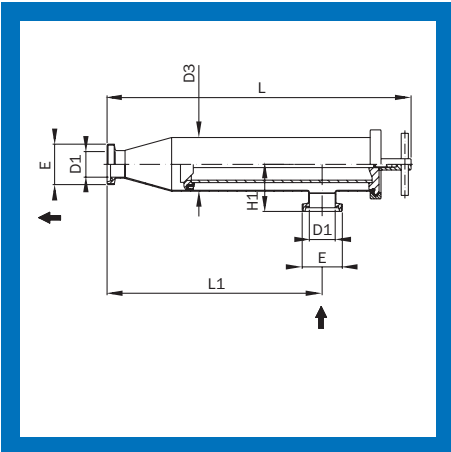

Angle Type Strainer Male/Male DIN

DN DIN	D1	D3	E	H1	L	L1	Weight [kg]
25	26	70	Rd 52 x 1/6"	66	556	415	4,3
32	32	70	Rd 58 x 1/6"	69	548	407	4,3
40	38	70	Rd 65 x 1/6"	70	538	397	4,4
50	50	104	Rd 78 x 1/6"	91	592	419	7,7
65	66	104	Rd 95 x 1/6"	96	568	395	7,9
80	81	154	Rd 110 x 1/4"	125	782	573	17,6
100	100	154	Rd 130 x 1/4"	134	757	548	17,7
125	125	204	Rd 160 x 1/4"	156	931	656	30,0
150	150	204	Rd 190 x 1/4"	159	930	655	39,2

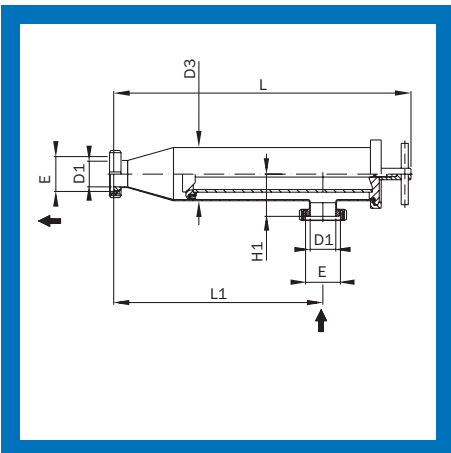

Angle Type Strainer Liner/Liner DIN

DN DIN	D1	D3	E	H1	L	L1	Weight [kg]
25	26	70	Rd 52 x 1/6"	59	549	408	4,6
32	32	70	Rd 58 x 1/6"	62	541	400	4,7
40	38	70	Rd 65 x 1/6"	63	531	390	4,8
50	50	104	Rd 78 x 1/6"	84	585	412	8,3
65	66	104	Rd 95 x 1/6"	88	560	387	8,9
80	81	154	Rd 110 x 1/4"	117	774	565	18,8
100	100	154	Rd 130 x 1/4"	124	747	538	19,4
125	125	204	Rd 160 x 1/4"	144	919	644	30,0
150	150	204	Rd 190 x 1/4"	146	917	642	39,2

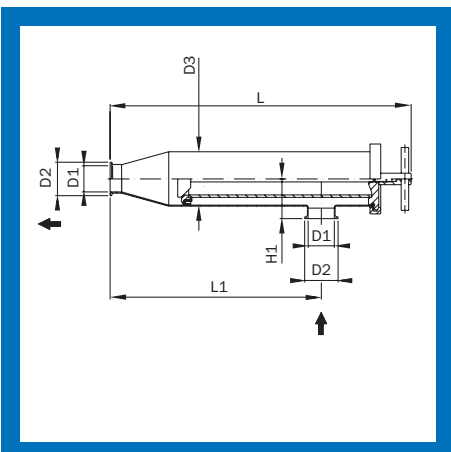

Angle Type Strainer Clamp/Clamp DIN

DN DIN	D1	D2	D3	H1	L	L1	Weight [kg]
25	26	50.5	70	59	548	408	4,2
32	32	50.5	70	59	538	397	4,1
40	38	50.5	70	59	526	386	4,1
50	50	64	104	78	578	406	7,3
65	66	91	104	84	556	383	7,5
80	81	106	154	108	767	556	16,8
100	100	119	154	108	731	522	16,6
125	125	155	204	138	913	638	30,0
150	150	183	204	137	908	633	39,2

Angle Type Strainers and Accessories

Angle Type Strainer Weld/Weld DIN

1.4301 (304)/EPDM Slotted Strainer Tube 0,5			1.4404 (316L)/EPDM Slotted Strainer Tube 0,5	
DN DIN	Price/EUR	Article No.	Price/EUR	Article No.
25	240,00	61029 211 025 10	299,00	61029 211 025 30
32	250,00	61029 211 032 10	319,00	61029 211 032 30
40	310,00	61029 211 040 10	371,00	61029 211 040 30
50	340,00	61029 211 050 10	402,00	61029 211 050 30
65	380,00	61029 211 065 10	453,00	61029 211 065 30
80	600,00	61029 211 080 10	690,00	61029 211 080 30
100	655,00	61029 211 100 10	881,00	61029 211 100 30
125	1953,00	61019 211 125 10	2331,00	61019 211 125 30
150	2419,00	61019 211 150 10	2890,00	61019 211 150 30

Angle Type Strainer Male/Male DIN

1.4301 (304)/EPDM Slotted Strainer Tube 0,5			1.4404 (316L)/EPDM Slotted Strainer Tube 0,5	
DN DIN	Price/EUR	Article No.	Price/EUR	Article No.
25	251,00	61029 111 025 10	314,00	61029 111 025 30
32	263,00	61029 111 032 10	336,00	61029 111 032 30
40	323,00	61029 111 040 10	388,00	61029 111 040 30
50	355,00	61029 111 050 10	422,00	61029 111 050 30
65	403,00	61029 111 065 10	483,00	61029 111 065 30
80	635,00	61029 111 080 10	736,00	61029 111 080 30
100	707,00	61029 111 100 10	950,00	61029 111 100 30
125	2047,00	61019 111 125 10	*	61019 111 125 30
150	2581,00	61019 111 150 10	*	61019 111 150 30

Angle Type Strainer Liner/Liner DIN

1.4301 (304)/EPDM Slotted Strainer Tube 0,5			1.4404 (316L)/EPDM Slotted Strainer Tube 0,5	
DN DIN	Price/EUR	Article No.	Price/EUR	Article No.
25	259,00	61029 311 025 10	320,00	61029 311 025 30
32	271,00	61029 311 032 10	342,00	61029 311 032 30
40	332,00	61029 311 040 10	396,00	61029 311 040 30
50	366,00	61029 311 050 10	431,00	61029 311 050 30
65	419,00	61029 311 065 10	497,00	61029 311 065 30
80	662,00	61029 311 080 10	759,00	61029 311 080 30
100	743,00	61029 311 100 10	981,00	61029 311 100 30
125	2123,00	61019 311 125 10	2607,00	61019 311 125 30
150	2755,00	61019 311 150 10	3315,00	61019 311 150 30

Angle Type Strainer Clamp/Clamp DIN

1.4301 (304)/EPDM Slotted Strainer Tube 0,5			1.4404 (316L)/EPDM Slotted Strainer Tube 0,5	
DN DIN	Price/EUR	Article No.	Price/EUR	Article No.
25	255,00	61029 411 025 10	316,00	61029 411 025 30
32	265,00	61029 411 032 10	336,00	61029 411 032 30
40	325,00	61029 411 040 10	388,00	61029 411 040 30
50	356,00	61029 411 050 10	421,00	61029 411 050 30
65	402,00	61029 411 065 10	480,00	61029 411 065 30
80	640,00	61029 411 080 10	737,00	61029 411 080 30
100	714,00	61029 411 100 10	948,00	61029 411 100 30
125	2050,00	61019 411 125 10	2520,00	61019 411 125 30
150	2537,00	61019 411 150 10	3068,00	61019 411 150 30

Angle Type Strainers and Accessories

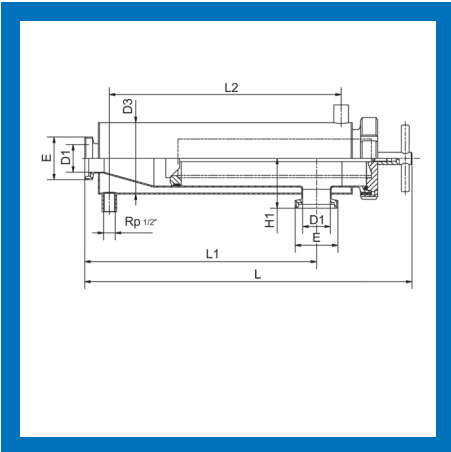

Angle Type Strainer heatable Male/Male DIN

DN DIN	D1	D3	E	H1	L	L1	L2	Weight [kg]
25	26	104	Rd 52 x 1/6"	86	556	415	399	6,8
40	38	104	Rd 65 x 1/6"	79	538	397	381	6,8
50	50	129	Rd 78 x 1/6"	90	592	419	419	6,5
65	66	129	Rd 95 x 1/6"	91	568	395	393	6,2
80	81	204	Rd 110 x 1/4"	155	782	573	588	14,1
100	100	204	Rd 130 x 1/4"	154	757	548	563	24,4

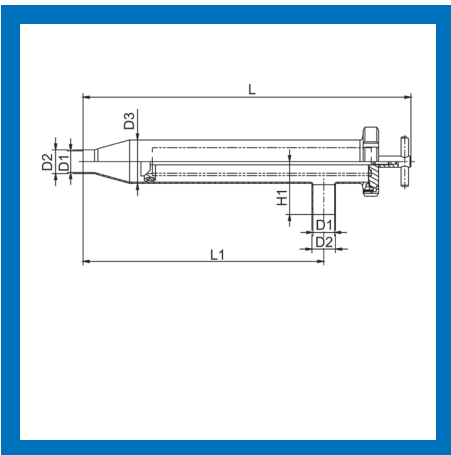

Angle Type Strainer Inch Weld/Weld

DN Inch	D1	D2	D3	H1	L	L1	Weight [kg]
1"	22.2	25.4	70	82	548	407	4,1
1 1/2"	34.9	38.1	70	85	529	388	4,1
2"	47.6	50.8	104	115	587	414	7,4
2 1/2"	60.3	63.5	104	115	560	387	7,3
3"	72.9	76.1	154	150	772	563	16,6
4"	97.6	101.6	154	167	724	515	16,7

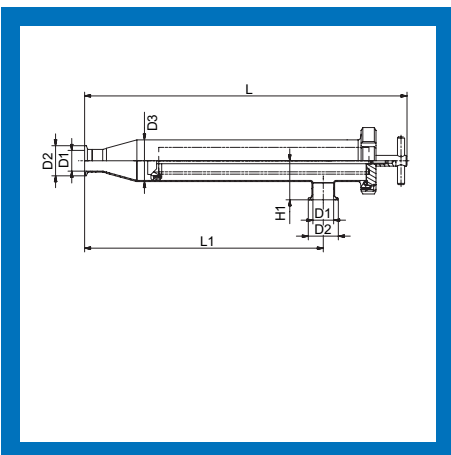

Angle Type Strainer Clamp/Clamp Inch

DN Inch	D1	D2	D3	H1	L	L1	Weight [kg]
1"	22.1	50.5	70	66	560	420	4,2
1 1/2"	34.8	50.5	70	66	541	401	4,1
2"	47.5	64	104	85	599	427	7,4
2 1/2"	60.2	77.5	104	85	572	400	7,4
3"	72.9	91	154	109	784	576	16,6
4"	97.4	119	154	109	736	528	16,7

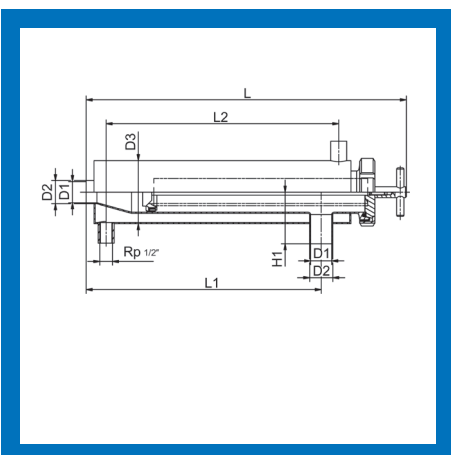

Angle Type Strainer heatable Weld/Weld Inch

DN Inch	D1	D2	D3	H1	L	L1	L2	Weight [kg]
1"	22,2	25,4	104	82	548	407	404	6,6
1 1/2"	34,9	38,1	104	85	529	388	384	6,5
2"	47,6	50,8	129	115	587	414	424	10,6
2 1/2"	60,3	63,5	129	115	560	387	393	10,3
3"	72,9	76,1	204	150	772	563	569	25,6
4"	97,6	101,6	204	167	724	515	522	25,1

Angle Type Strainers and Accessories

Angle Type Strainer heatable Male/Male DIN

1.4301 (304)/EPDM Slotted Strainer Tube 0,5			1.4404 (316L)/EPDM Slotted Strainer Tube 0,5	
DN DIN	Price/EUR	Article No.	Price/EUR	Article No.
25	549,00	62029 111 025 10	612,00	62029 111 025 30
40	608,00	62029 111 040 10	673,00	62029 111 040 30
50	707,00	62029 111 050 10	774,00	62029 111 050 30
65	746,00	62029 111 065 10	826,00	62029 111 065 30
80	1191,00	62029 111 080 10	1292,00	62029 111 080 30
100	1270,00	62029 111 100 10	1512,00	62029 111 100 30

Angle Type Strainer Inch Weld/Weld

1.4301 (304)/EPDM Slotted Strainer Tube 0,5			1.4404 (316L)/EPDM Slotted Strainer Tube 0,5	
DN Inch	Price/EUR	Article No.	Price/EUR	Article No.
1"	240,00	61029 711 100 10	299,00	61029 711 100 30
1 1/2"	310,00	61029 711 112 10	371,00	61029 711 112 30
2"	340,00	61029 711 200 10	402,00	61029 711 200 30
2 1/2"	380,00	61029 711 212 10	453,00	61029 711 212 30
3"	600,00	61029 711 300 10	690,00	61029 711 300 30
4"	655,00	61029 711 400 10	881,00	61029 711 400 30

Angle Type Strainer Clamp/Clamp Inch

1.4301 (304)/EPDM Slotted Strainer Tube 0,5			1.4404 (316L)/EPDM Slotted Strainer Tube 0,5	
DN Inch	Price/EUR	Article No.	Price/EUR	Article No.
1"	255,00	61029 A11 100 10	316,00	61029 A11 100 30
1 1/2"	325,00	61029 A11 112 10	388,00	61029 A11 112 30
2"	356,00	61029 A11 200 10	421,00	61029 A11 200 30
2 1/2"	402,00	61029 A11 212 10	480,00	61029 A11 212 30
3"	640,00	61029 A11 300 10	737,00	61029 A11 300 30
4"	714,00	61029 A11 400 10	948,00	61029 A11 400 30

Angle Type Strainer heatable Weld/Weld Inch

1.4301 (304)/EPDM Slotted Strainer Tube 0,5			1.4404 (316L)/EPDM Slotted Strainer Tube 0,5	
DN Inch	Price/EUR	Article No.	Price/EUR	Article No.
1"	538,00	62029 711 100 10	597,00	62029 711 100 30
1 1/2"	595,00	62029 711 112 10	656,00	62029 711 112 30
2"	692,00	62029 711 200 10	754,00	62029 711 200 30
2 1/2"	723,00	62029 711 212 10	796,00	62029 711 212 30
3"	1156,00	62029 711 300 10	1246,00	62029 711 300 30
4"	1218,00	62029 711 400 10	1444,00	62029 711 400 30

Angle Type Strainers and Accessories

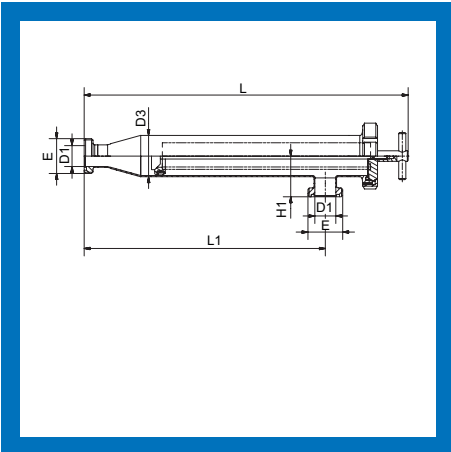

Angle Type Strainer Male/Male SMS

DN SMS	D1	D3	E	H1	L	L1	Weight [kg]
25	22.6	70	Rd 40 x 1/6"	66	562	421	4,2
38	35.6	70	Rd 60 x 1/6"	69	547	406	4,4
51	48.6	104	Rd 70 x 1/6"	91	610	437	7,7
63.5	60.3	104	Rd 85 x 1/6"	96	584	411	8,0
76.1	72.9	154	Rd 98 x 1/6"	120	796	587	17,4
101.6	97.6	154	Rd 132 x 1/6"	130	759	550	19,2

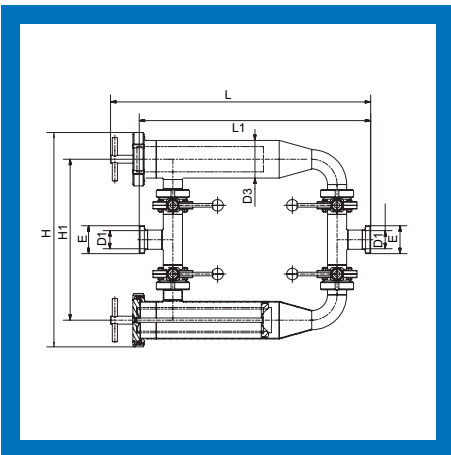

Angle Type Strainer Combination

DN DIN	D1	D3	E	H	H1	L	L1	Weight [kg]
25	26	70	Rd 52 x 1/6"	446	335	649	580	15,7
32	32	70	Rd 58 x 1/6"	454	343	648	584	15,2
40	38	70	Rd 65 x 1/6"	490	379	647	588	17,0
50	50	104	Rd 78 x 1/6"	592	445	720	640	26,4
65	66	104	Rd 95 x 1/6"	612	465	713	645	29,8
80	81	154	Rd 110 x 1/4"	748	539	942	848	58,9
100	100	154	Rd 130 x 1/4"	798	589	933	854	64,3

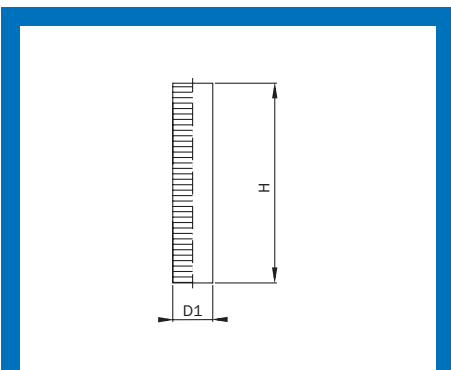

Slotted Strainer Tube

DN DIN	D1	H	Free screening area (cm ²)		Weight [kg]
			0.5 mm	1 mm	
25 - 40	45	353	161	241	approx. 0.5
50 - 65	70	350	248	372	approx. 0.7
80 - 100	110	470	527	791	approx. 1.5
125 - 150	164	750	1139	1574	approx. 3.7

Other gap width
on request from 0.05 mm.

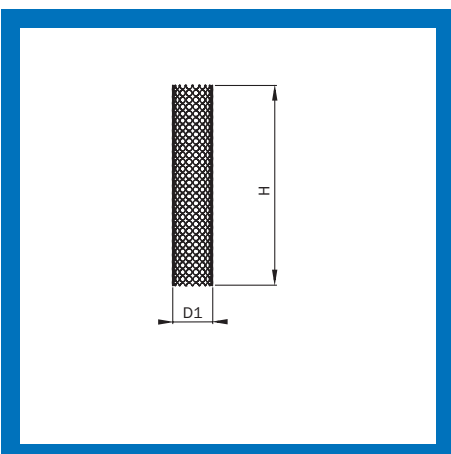

Perforated Strainer

DN DIN	D1	H	Free screening area (cm ²)				Weight [kg]
			1 mm	1.5 mm	2.5 mm	8 mm	
25 - 40	45	353	126.76	152.71	166.68	191.13	approx. 0.3
50 - 65	70	350	195.5	235.53	257.08	294.79	approx. 0.4
80 - 100	110	470	412.55	497.01	542.48	622.07	approx. 0.8
125 - 150	164	750		1182.38	1290.58	1479.91	approx. 2.0

Angle Type Strainers and Accessories

Angle Type Strainer Male/Male SMS

1.4301 (304)/EPDM Slotted Strainer Tube 0,5			1.4404 (316L)/EPDM Slotted Strainer Tube 0,5	
DN SMS	Price/EUR	Article No.	Price/EUR	Article No.
25	251,00	61029 F11 100 10	314,00	61029 F11 100 30
38	323,00	61029 F11 112 10	388,00	61029 F11 112 30
51	355,00	61029 F11 200 10	422,00	61029 F11 200 30
63.5	403,00	61029 F11 212 10	483,00	61029 F11 212 30
76.1	635,00	61029 F11 300 10	736,00	61029 F11 300 30
101.6	707,00	61029 F11 400 10	950,00	61029 F11 400 30

Angle Type Strainer Combination

1.4301 (304)/EPDM Slotted Strainer Tube 0,5			1.4404 (316L)/EPDM Slotted Strainer Tube 0,5	
DN DIN	Price/EUR	Article No.	Price/EUR	Article No.
25	1058,00	61029 811 025 10	1221,00	61029 811 025 30
32	1108,00	61029 811 032 10	1254,00	61029 811 032 30
40	1072,00	61029 811 040 10	1203,00	61029 811 040 30
50	1301,00	61029 811 050 10	1467,00	61029 811 050 30
65	1507,00	61029 811 065 10	1713,00	61029 811 065 30
80	2537,00	61029 811 080 10	2934,00	61029 811 080 30
100	2763,00	61029 811 100 10	3163,00	61029 811 100 30

Slotted Strainer Tube

1.4404 (316L) / Gap width 0.5 mm			1.4404 (316L) / Gap width 1 mm	
DN DIN	Spare part price/EUR	Article No.	Spare part price/EUR	Article No.
25 - 40	105,00	61020 010 040 70	105,00	61020 020 040 70
50 - 65	125,00	61020 010 065 70	125,00	61020 020 065 70
80 - 100	179,00	61020 010 100 70	179,00	61020 020 100 70
125 - 150	439,00	61020 010 150 70	439,00	61020 020 150 70

Perforated Strainer

1.4404 (316L) / Perforation 1 mm			1.4404 (316L) / Perforation 1.5 mm		1.4404 (316L) / Perforation 2.5 mm		1.4404 (316L) / Perforation 8 mm	
DN DIN	Spare part price/EUR	Article No.	Spare part price/EUR	Article No.	Spare part price/EUR	Article No.	Spare part price/EUR	Article No.
25 - 40	89,00	61022 020 040 30	89,00	61022 040 040 30	84,00	61022 050 040 30	84,00	61022 060 040 30
50 - 65	106,00	61022 020 065 30	106,00	61022 040 065 30	100,00	61022 050 065 30	100,00	61022 060 065 30
80 - 100	152,00	61022 020 100 30	152,00	61022 040 100 30	143,00	61022 050 100 30	143,00	61022 060 100 30
125 - 150			373,00	61022 040 150 30	351,00	61022 050 150 30	351,00	61022 060 150 30

Angle Type Strainers and Accessories

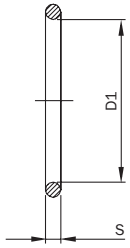

Seal Ring for Tie Rod

DN DIN	D1	S	Weight [kg]
25 - 40	6	2	0.01
50 - 65	8	2	0.01
80 - 150	12	2	0.01

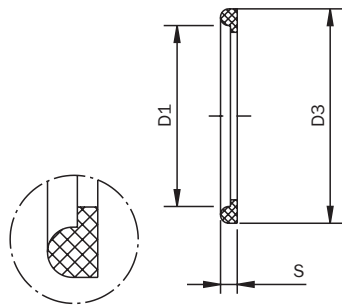

Seal Ring for Cap with Screw Connection

DN DIN	D1	D3	S	Weight [kg]
25-40	71	81	6	0.009
50-65	104	114	6	0.016
80-100	155	167	7	0.026
125-150	204	217	7	0.036

For variant with Nut

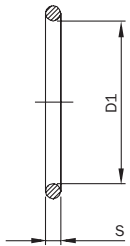

Seal Ring for Cap with Clamp Connection (old version)

DN DIN	D1	S	Weight [kg]
25 - 40	53.34	5.33	0.02
50 - 65	86.5	5	0.03
80 - 100	see grooved ring		
125 - 150	204	7	0.036

For variant with Heavy Duty Clamp

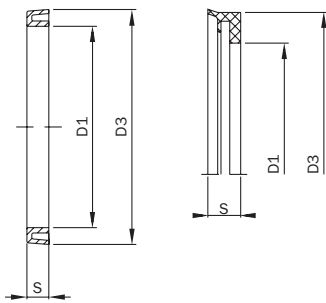

Grooved Ring

DN DIN	D1	D3	S	Weight [kg]
25 - 40	50	65	11	0.01
50 - 65	92	100	10	0.01
80 - 100	120	148	15	0.07
125 - 150	190	200	12.5	0.07

DN25 - DN65
DN125 - DN150

DN80 - DN100

Angle Type Strainers and Accessories

Seal Ring for Tie Rod

EPDM		NBR		FKM		
DN DIN	Price/EUR	Article No.	Price/EUR	Article No.	Price/EUR	Article No.
25 - 40	2,30	10605 000 006 54	2,00	10605 000 006 55	2,60	10605 000 006 56
50 - 65	2,40	10605 000 008 54	2,10	10605 000 008 55	2,70	10605 000 008 56
80 - 150	2,50	10605 000 012 04	2,20	10605 000 012 05	2,80	10605 000 012 06

Seal Ring for Cap with Screw Connection

EPDM		NBR		FKM		
DN DIN	Price/EUR	Article No.	Price/EUR	Article No.	Price/EUR	Article No.
25-40	1,65	10008 000 065 56	1,50	10004 000 065 56	9,20	10006 000 065 56
50-65	2,30	10008 000 100 56	2,00	10004 000 100 56	15,60	10006 000 100 56
80-100	5,40	10008 000 150 56	5,10	10004 000 150 56	32,00	10006 000 150 56
125-150	21,20	10008 000 200 54	17,70	10004 000 200 54	60,00	10006 000 200 54

Seal Ring for Cap with Clamp Connection (old version)

EPDM		NBR		FKM		
DN DIN	Price/EUR	Article No.	Price/EUR	Article No.	Price/EUR	Article No.
25 - 40	5,37	10605 000 053 31	5,13	10605 000 053 30	9,99	10605 000 053 32
50 - 65	5,78	1129 00 84 1	5,33	1129 00 84 3	11,56	1129 00 84 2
80 - 100	16,51	61019 010 004 1	19,84	61019 010 004 3	56,10	61019 010 004 2
125 - 150	21,16	10008 000 200 54	17,63	10004 000 200 54	59,63	10006 000 200 54

Grooved Ring

EPDM		NBR		FKM		
DN DIN	Price/EUR	Article No.	Price/EUR	Article No.	Price/EUR	Article No.
25 - 40	7,36	37503	8,82	37508	16,44	37521
50 - 65	7,29	37502	8,74	37507	14,28	37522
80 - 100	16,51	61019 010 004 1	19,84	61019 010 004 3	56,10	61019 010 004 2
125 - 150	51,15	37509	51,15	37510	137,80	37531

Dirt Traps and Accessories



AWH dirt traps protect your product and plant components, pumps, heat exchangers etc., from foreign objects that can cause malfunctions. Our dirt traps are Y-shaped (Y filter). The direction of flow is always from the inside to the outside. The trap should be installed so that the filter insert is removed from below. Its streamlined shape ensures reliable processes in a simple and cost-effective way.

We offer gap filters with gap widths of 1.0 mm, 0.5 mm and 0.25 mm. Compared to conventional perforated sheets, slotted tubes offer much greater pressure stability and a larger screening area.

Technical Parameter

- Material:** in contact with the product: 1.4301 (304) / 1.4307 (304L), 1.4404 (316L)
not in contact with the product: 1.4301 (304) / 1.4307 (304L)
strainer: 1.4435 (316L)
- Surface:** inside: $Ra \leq 0.8 \mu\text{m}$ (strainer and welding seam higher)
outside: electro polished
- Sealing:** clamp seal ring DIN 32676: (other materials on request)
- Compressive strength:** nominal pressure: PN10
- Connections:** standard: welding ends DIN EN 10357
alternative: male ends DIN 11851
alternative: clamp ends DIN 32676
(other variants on request)

Overview Kv-Value

The Kv-value describes the rate of flow in m^3/h of water up to 15°C with a pressure loss of 1 bar ($=\Delta p$)

Kv-Value							
Gap width in mm	DN	25	40	50	65	80	100
1	Kv	16.7	33.5	51.5	86.7	127.6	192.3
0.5	Kv	15.1	28.6	43	69.2	103.1	155.2
0.25	Kv	13.6	24.8	36.5	56.2	83.6	127.9

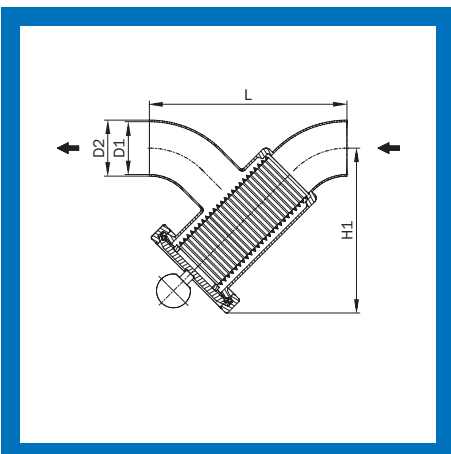

Dirt Trap Weld/Weld DIN

DN DIN	D1	D2	H1	L	Weight [kg]
25	26	29	123	147	1.61
40	38	41	153	172,5	2.44
50	50	53	156	187	2.50
65	66	70	179	215,5	3.39
80	81	85	197	240,5	4.13
100	100	104	235	269,5	6.37

Dirt Traps and Accessories

Explosion View

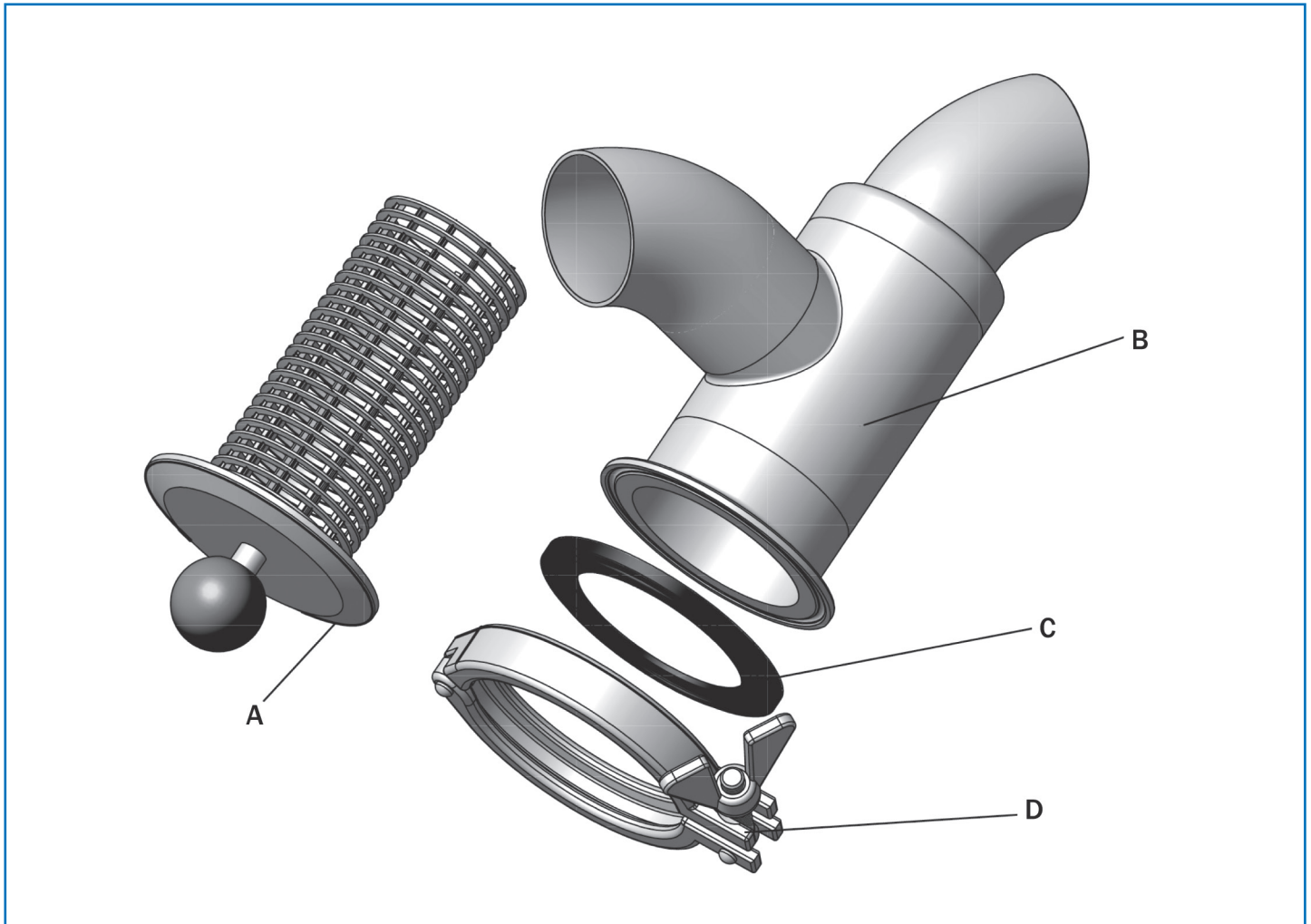

- A** Strainer insert
- B** Casing
- C** Clamp seal ring
- D** Heavy duty clamp

Dirt Trap Weld/Weld DIN

1.4301 (304)/EPDM		1.4404 (316L)/EPDM Gap width 1 mm		
DN DIN	Price/EUR	Article No.	Price/EUR	Article No.
25	215,00	61025 221 025 10	260,00	61025 221 025 30
40	268,00	61025 221 040 10	329,00	61025 221 040 30
50	283,00	61025 221 050 10	360,00	61025 221 050 30
65	385,00	61025 221 065 10	484,00	61025 221 065 30
80	480,00	61025 221 080 10	603,00	61025 221 080 30
100	696,00	61025 221 100 10	907,00	61025 221 100 30

Dirt Traps and Accessories

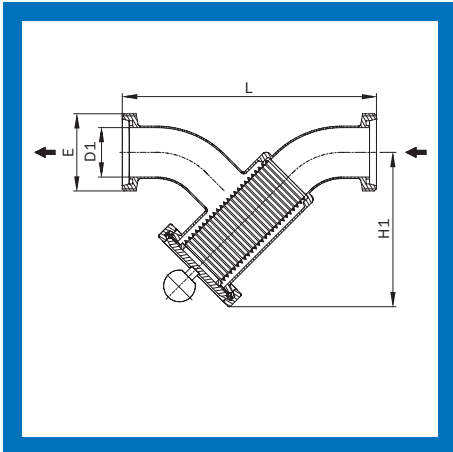

Dirt Trap Male/Male DIN

DN DIN	D1	E	H1	L	Weight [kg]
25	26	Rd 52 x 1/6"	123	205	1.89
40	38	Rd 65 x 1/6"	153	237,5	2.58
50	50	Rd 78 x 1/6"	156	256	3.03
65	66	Rd 95 x 1/6"	179	294,5	4.20
80	81	Rd 110 x 1/4"	197	329,5	5.39
100	100	Rd 130 x 1/4"	235	377,5	7.94

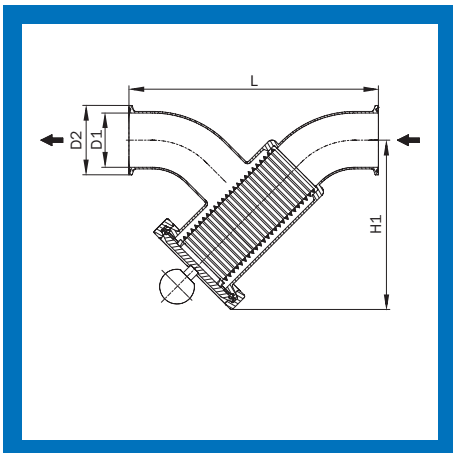

Dirt Trap Clamp/Clamp DIN

DN DIN	D1	D2	H1	L	Weight [kg]
25	26	50.5	123	189	1.75
40	38	50.5	153	214,5	2.54
50	50	64	156	229	2.63
65	66	91	179	270,5	3.75
80	81	106	197	295,5	4.58
100	100	119	235	325,5	6.81

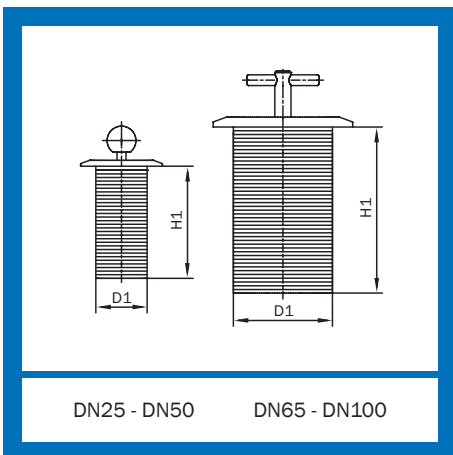

Strainer Insert for Dirt Trap

DN DIN	D1	H1	Free screening area (cm ²)			Weight [kg]
			0.25 mm	0.5 mm	1.0 mm	
25	38	100	21	37	91	0.87
40 - 50	57	125	40	71	172	1.24
65	73	145	61	106	257	1.56
80	85	160	79	137	331	1.86
100	110	185	119	205	498	2.34

DN25 - DN50

DN65 - DN100

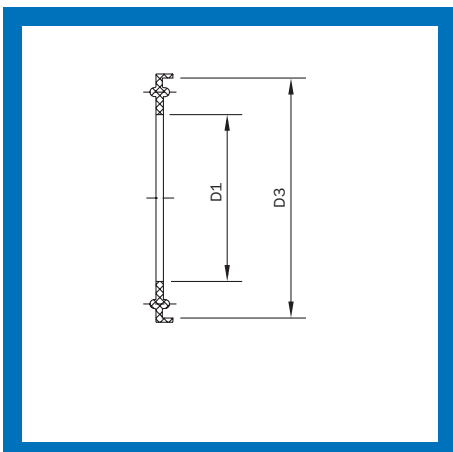

Clamp Seal Ring

DN DIN	D1	D3
25	50.2	64
40 - 50	66.2	91
65	81.2	106
80	100.2	119
100	125.2	155

Dirt Traps and Accessories

Dirt Trap Male/Male DIN

1.4301 (304)/EPDM			1.4404 (316L)/EPDM Gap width 1 mm		
DN DIN	Price/EUR	Article No.	Price/EUR	Article No.	
25	235,00	61025 121 025 10	284,00	61025 121 025 30	
40	291,00	61025 121 040 10	356,00	61025 121 040 30	
50	308,00	61025 121 050 10	390,00	61025 121 050 30	
65	428,00	61025 121 065 10	534,00	61025 121 065 30	
80	534,00	61025 121 080 10	668,00	61025 121 080 30	
100	768,00	61025 121 100 10	995,00	61025 121 100 30	

Dirt Trap Clamp/Clamp DIN

1.4301 (304)/EPDM			1.4404 (316L)/EPDM Gap width 1 mm		
DN DIN	Price/EUR	Article No.	Price/EUR	Article No.	
25	239,00	61025 421 025 10	286,00	61025 421 025 30	
40	293,00	61025 421 040 10	356,00	61025 421 040 30	
50	309,00	61025 421 050 10	389,00	61025 421 050 30	
65	427,00	61025 421 065 10	531,00	61025 421 065 30	
80	539,00	61025 421 080 10	669,00	61025 421 080 30	
100	775,00	61025 421 100 10	994,00	61025 421 100 30	

Strainer Insert for Dirt Trap

1.4404 (316L) / Gap width 0.25 mm			1.4404 (316L) / Gap width 0.5 mm		1.4404 (316L) / Gap width 1.0 mm	
DN DIN	Price/EUR	Article No.	Price/EUR	Article No.	Price/EUR	Article No.
25	136,00	61026 090 025 30	105,00	61026 010 025 30	105,00	61026 020 025 30
40 - 50	170,00	61026 090 050 30	126,00	61026 010 050 30	126,00	61026 020 050 30
65	247,00	61026 090 065 30	169,00	61026 010 065 30	169,00	61026 020 065 30
80	330,00	61026 090 080 30	202,00	61026 010 080 30	202,00	61026 020 080 30
100	391,00	61026 090 100 30	253,00	61026 010 100 30	253,00	61026 020 100 30

Clamp Seal Ring

EPDM			NBR		Silicone		FKM	
DN DIN	Price/EUR	Article No.	Price/EUR	Article No.	Price/EUR	Article No.	Price/EUR	Article No.
25	2,15	10514 000 050 55	1,94	10515 000 050 54	2,55	10515 000 050 55	10,90	10516 000 050 55
40 - 50	4,15	10514 000 065 55	3,90	10515 000 065 54	4,40	10515 000 065 55	12,25	10516 000 065 55
65	4,60	10514 000 080 55	4,10	10515 000 080 54	4,90	10515 000 080 55	22,80	10516 000 080 55
80	5,70	10514 000 100 55	5,15	10515 000 100 54	8,95	10515 000 100 55	24,15	10516 000 100 55
100	9,70	10514 000 125 55	8,45	10515 000 125 54	10,70	10515 000 125 55	43,45	10516 000 125 55

Inline Sight Glasses and Accessories



The AWH inline sight glass presented in this catalogue offers a range of advantages over conventional products:

1. Its design prevents incorrect assembly thanks to the following:
 - stud bolt with stop collar, which also increases resistance to fracture
 - predefined pre-compression of the seal ring on the glass cylinder
 - use of standard components from the catalogue
 - self-locking nuts
2. Optimum visibility thanks to easy-to-clean safety screen made of shock-resistant plastic. Does not restrict visibility like stamped sheet metal.
3. Available in nominal diameters of DN10 - DN150.
4. The pressure specifications for inline sight glasses can be found in the table on glass cylinders for inline sight glasses.

Technical Parameter

Material:	in contact with the product: 1.4301 (304) /1.4307 (304L), 1.4404 (316L) not in contact with the product: 1.4301 (304) /1.4307 (304L) Glass cylinder: Borosilicat
Surface:	inside: $Ra \leq 0.8 \mu m$
Compressive strength:	nominal pressure: PN10 up to DN65, larger dimensions see table glass cylinders for inline sight glasses
Connections:	standard: welding ends DIN EN 10357 alternative: male ends DIN 11851 alternative: liner ends DIN 11851 (other variants on request)

Technical Parameter Polycarbonat (safety screen for inline sight glass)

Color:	transparent (translucency > 86%)
Material:	thermoplastic polymer
Operating temperature:	up to about 120°C, for short duration during cleaning
Typical field of use:	highly fracture-resistant and shock-resistant, excellent translucency resistant to mineral acids, many organic acids, oxidation and reducing agents, neutral and acidic saline solutions, many different fats, waxes and oils
Limitations of use:	not very scratch-resistant, not intended for parts that come into contact with the product not resistant to aqueous or alcoholic alkalis, ammonia gas or solutions and amines of these heavy swelling with benzene, chlorobenzene, tetralin, acetone, ethyl acetate, acetonitrile and carbon tetrachloride
Recommended cleaning agent:	company WIGOL: 30 20 04, 30 20 00, 1085, 60 80 25; company WEBCO: „alcip“

Installation Instructions

During assembly, ensure that a suitable gasket is installed on both sides of the glass cylinder. The surfaces of the gaskets must be free of impurities and undamaged. Nuts must be tightened crossed and in several increments.

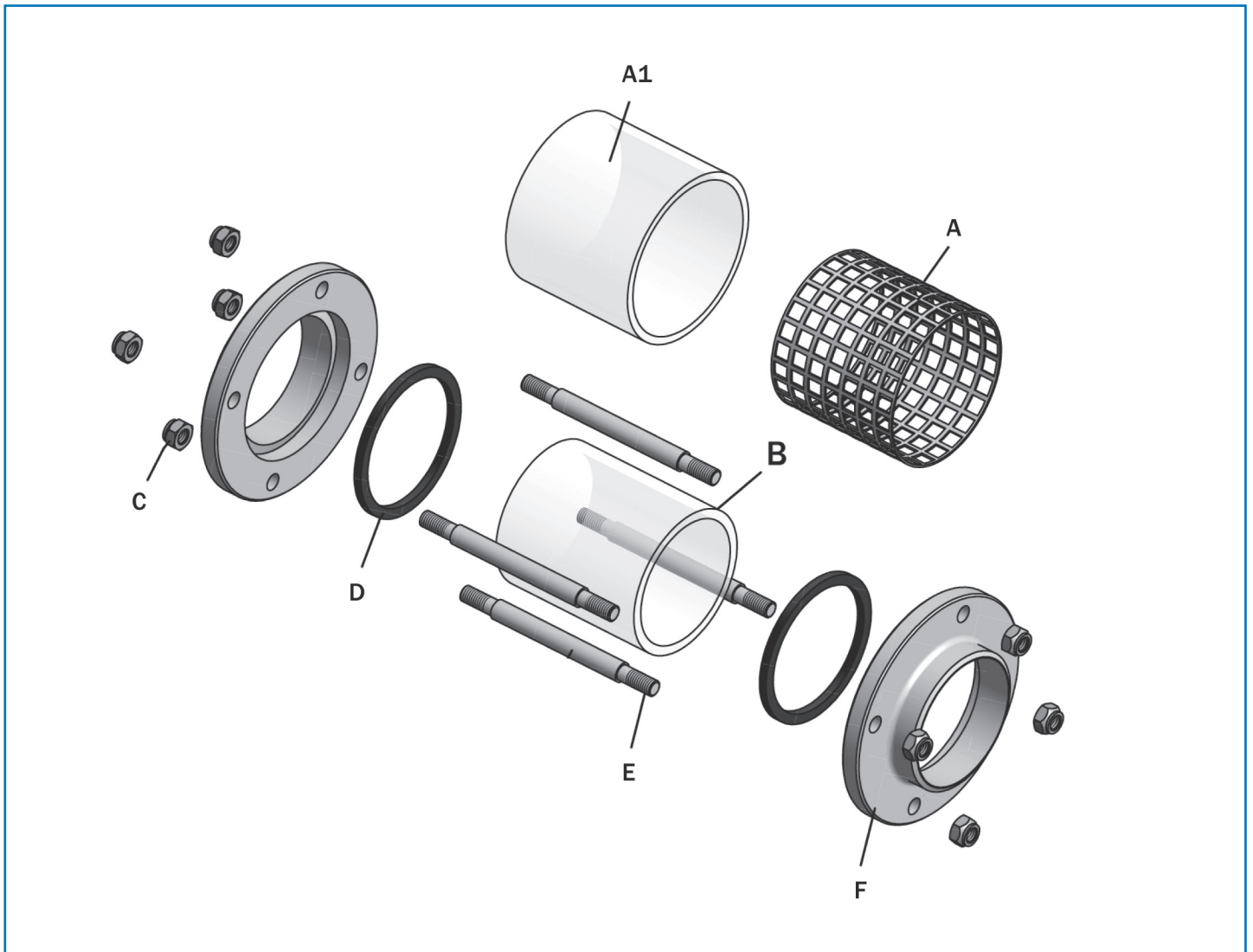

- A** Safety screen perforated plate
- A1** Safety screen polycarbonat
- B** Glass cylinder
- C** Hexagonal nut
- D** Seal ring
- E** Studbolt
- F** Flange

Inline Sight Glasses and Accessories

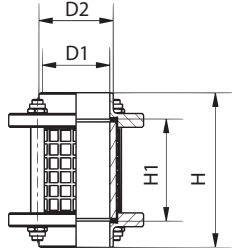

Delivery only with safety screen.

Inline Sight Glass Weld/Weld DIN

DN DIN	D1	D2	H	H1	Weight [kg]
10	10	15	88	60	0.25
15	16	21	88	60	0.30
20	20	25	88	60	0.73
25	26	31	98	70	0.75
32	32	37	104	70	0.76
40	38	43	112	70	1.08
50	50	55	112	70	1.34
65	66	72	127	85	1.90
80	81	87	135	85	2.35
100	100	106	169	115	2.80
125	125	132	202	160	6.35
150	150	157	216	170	7.11

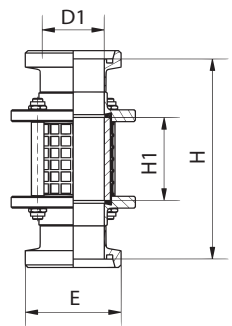

Delivery only with safety screen.

Inline Sight Glass Male/Male DIN

DN DIN	D1	E	H	H1	Weight [kg]
10	10	Rd 28 x 1/8"	122	60	0.32
15	16	Rd 34 x 1/8"	122	60	0.39
20	20	Rd 44 x 1/6"	124	60	0.90
25	26	Rd 52 x 1/6"	142	70	1.00
32	32	Rd 58 x 1/6"	154	70	1.08
40	38	Rd 65 x 1/6"	164	70	1.50
50	50	Rd 78 x 1/6"	168	70	1.94
65	66	Rd 95 x 1/6"	191	85	2.80
80	81	Rd 110 x 1/4"	209	85	3.10
100	100	Rd 130 x 1/4"	257	115	4.36
125	125	Rd 160 x 1/4"	270	160	8.80
150	150	Rd 190 x 1/4"	290	170	10.50

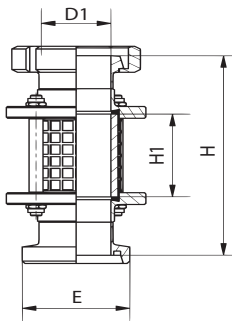

Delivery only with safety screen.

Inline Sight Glass Male/Liner DIN

DN DIN	D1	E	H	H1	Weight [kg]
10	10	Rd 28 x 1/8"	122	60	0.38
15	16	Rd 34 x 1/8"	122	60	0.45
20	20	Rd 44 x 1/6"	124	60	0.69
25	26	Rd 52 x 1/6"	142	70	1.02
32	32	Rd 58 x 1/6"	154	70	1.25
40	38	Rd 65 x 1/6"	164	70	1.67
50	50	Rd 78 x 1/6"	168	70	2.17
65	66	Rd 95 x 1/6"	191	85	3.26
80	81	Rd 110 x 1/4"	209	85	3.71
100	100	Rd 130 x 1/4"	257	115	5.10
125	125	Rd 160 x 1/4"	270	160	9.50
150	150	Rd 190 x 1/4"	290	170	11.30

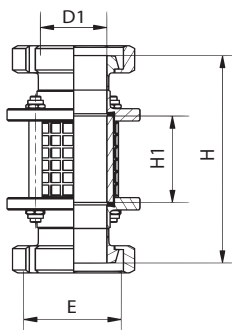

Delivery only with safety screen.

Inline Sight Glass Liner/Liner DIN

DN DIN	D1	E	H	H1	Weight [kg]
10	10	Rd 28 x 1/8"	122	60	0.44
15	16	Rd 34 x 1/8"	122	60	0.52
20	20	Rd 44 x 1/6"	124	60	1.08
25	26	Rd 52 x 1/6"	142	70	1.20
32	32	Rd 58 x 1/6"	154	70	1.41
40	38	Rd 65 x 1/6"	164	70	1.89
50	50	Rd 78 x 1/6"	168	70	2.50
65	66	Rd 95 x 1/6"	191	85	3.64
80	81	Rd 110 x 1/4"	209	85	4.27
100	100	Rd 130 x 1/4"	257	115	6.13
125	125	Rd 160 x 1/4"	270	160	10.20
150	150	Rd 190 x 1/4"	290	170	11.79

Inline Sight Glasses and Accessories

Inline Sight Glass Weld/Weld DIN

1.4301 (304)/NBR with safety screen perforated plate			1.4404 (316L)/NBR with safety screen perforated plate		1.4301 (304)/NBR with safety screen polycarbonate		1.4404 (316L)/NBR with safety screen polycarbonate	
DN DIN	Price/EUR	Article No.	Price/EUR	Article No.	Price/EUR	Article No.	Price/EUR	Article No.
10	67,98	6000 01 06 1/3	90,58	6000 01 06 2/3	62,74	6000 01 04 1/3	85,34	6000 01 04 2/3
15	70,21	6000 03 06 1/3	92,61	6000 03 06 2/3	64,64	6000 03 04 1/3	87,04	6000 03 04 2/3
20	75,92	6000 04 06 1/3	101,12	6000 04 06 2/3	68,74	6000 04 04 1/3	93,94	6000 04 04 2/3
25	57,28	6000 05 06 1/3	75,08	6000 05 06 2/3	49,94	6000 05 04 1/3	67,74	6000 05 04 2/3
32	58,73	6000 06 06 1/3	76,73	6000 06 06 2/3	51,60	6000 06 04 1/3	69,60	6000 06 04 2/3
40	62,62	6000 07 06 1/3	81,72	6000 07 06 2/3	54,47	6000 07 04 1/3	73,57	6000 07 04 2/3
50	67,31	6000 08 06 1/3	89,11	6000 08 06 2/3	58,41	6000 08 04 1/3	80,21	6000 08 04 2/3
65	84,70	6000 09 06 1/3	111,00	6000 09 06 2/3				
80	112,32	6000 10 06 1/3	148,02	6000 10 06 2/3	101,20	6000 10 04 1/3	137,90	6000 10 04 2/3
100	143,47	6000 12 06 1/3	190,17	6000 12 06 2/3	130,71	6000 12 04 1/3	177,41	6000 12 04 2/3
125	373,59	6000 13 06 1/3	506,69	6000 13 06 2/3				
150	712,70	6000 15 06 1/3	976,50	6000 15 06 2/3	691,58	6000 15 04 1/3	955,38	6000 15 04 2/3

Inline Sight Glass Male/Male DIN

1.4301 (304)/NBR with safety screen perforated plate			1.4404 (316L)/NBR with safety screen perforated plate		1.4301 (304)/NBR with safety screen polycarbonate		1.4404 (316L)/NBR with safety screen polycarbonate	
DN DIN	Price/EUR	Article No.	Price/EUR	Article No.	Price/EUR	Article No.	Price/EUR	Article No.
10	77,26	6001 01 06 1/3	118,08	6001 01 06 2/3	66,78	6001 01 04 1/3	112,84	6001 01 04 2/3
15	90,44	6001 03 06 1/3	121,91	6001 03 06 2/3	84,84	6001 03 04 1/3	116,34	6001 03 04 2/3
20	101,82	6001 04 06 1/3	136,92	6001 04 06 2/3	94,64	6001 04 04 1/3	129,74	6001 04 04 2/3
25	77,38	6001 05 06 1/3	103,18	6001 05 06 2/3	70,04	6001 05 04 1/3	95,84	6001 05 04 2/3
32	82,43	6001 06 06 1/3	109,43	6001 06 06 2/3	75,30	6001 06 04 1/3	102,30	6001 06 04 2/3
40	88,22	6001 07 06 1/3	117,52	6001 07 06 2/3	80,07	6001 07 04 1/3	109,37	6001 07 04 2/3
50	94,81	6001 08 06 1/3	127,11	6001 08 06 2/3	85,91	6001 08 04 1/3	118,21	6001 08 04 2/3
65	121,20	6001 09 06 1/3	162,10	6001 09 06 2/3				
80	163,12	6001 10 06 1/3	219,82	6001 10 06 2/3	152,00	6001 10 04 1/3	208,70	6001 10 04 2/3
100	216,07	6001 12 06 1/3	291,97	6001 12 06 2/3	203,31	6001 12 04 1/3	279,21	6001 12 04 2/3
125	508,79	6001 13 06 1/3	695,89	6001 13 06 2/3				
150	910,20	6001 15 06 1/3	1253,80	6001 15 06 2/3	889,08	6001 15 04 1/3	1232,68	6001 15 04 2/3

Inline Sight Glass Male/Liner DIN

1.4301 (304)/NBR with safety screen perforated plate			1.4404 (316L)/NBR with safety screen perforated plate		1.4301 (304)/NBR with safety screen polycarbonate		1.4404 (316L)/NBR with safety screen polycarbonate	
DN DIN	Price/EUR	Article No.	Price/EUR	Article No.	Price/EUR	Article No.	Price/EUR	Article No.
10	94,68	6003 01 06 1/3	121,08	6003 01 06 2/3	89,44	6003 01 04 1/3	115,84	6003 01 04 2/3
15	95,41	6003 03 06 1/3	128,71	6003 03 06 2/3	89,84	6003 03 04 1/3	123,14	6003 03 04 2/3
20	104,12	6003 04 06 1/3	139,92	6003 04 06 2/3	96,94	6003 04 04 1/3	132,74	6003 04 04 2/3
25	82,08	6003 05 06 1/3	109,58	6003 05 06 2/3	74,74	6003 05 04 1/3	102,24	6003 05 04 2/3
32	88,23	6003 06 06 1/3	118,33	6003 06 06 2/3	81,10	6003 06 04 1/3	111,20	6003 06 04 2/3
40	93,92	6003 07 06 1/3	125,72	6003 07 06 2/3	85,77	6003 07 04 1/3	117,57	6003 07 04 2/3
50	102,21	6003 08 06 1/3	137,41	6003 08 06 2/3	93,31	6003 08 04 1/3	128,51	6003 08 04 2/3
65	133,40	6003 09 06 1/3	179,30	6003 09 06 2/3				
80	178,62	6003 10 06 1/3	241,82	6003 10 06 2/3	167,50	6003 10 04 1/3	230,70	6003 10 04 2/3
100	243,17	6003 12 06 1/3	330,27	6003 12 06 2/3	230,41	6003 12 04 1/3	317,51	6003 12 04 2/3
125	547,29	6003 13 06 1/3	750,69	6003 13 06 2/3				
150	997,60	6003 15 06 1/3	1424,20	6003 15 06 2/3	976,48	6003 15 04 1/3	1403,08	6003 15 04 2/3

Inline Sight Glass Liner/Liner DIN

1.4301 (304)/NBR with safety screen perforated plate			1.4404 (316L)/NBR with safety screen perforated plate		1.4301 (304)/NBR with safety screen polycarbonate		1.4404 (316L)/NBR with safety screen polycarbonate	
DN DIN	Price/EUR	Article No.	Price/EUR	Article No.	Price/EUR	Article No.	Price/EUR	Article No.
10	92,08	6002 01 06 1/3	123,88	6002 01 06 2/3	86,84	6002 01 04 1/3	118,64	6002 01 04 2/3
15	99,01	6002 03 06 1/3	134,21	6002 03 06 2/3	93,44	6002 03 04 1/3	128,64	6002 03 04 2/3
20	106,52	6002 04 06 1/3	143,02	6002 04 06 2/3	99,34	6002 04 04 1/3	135,84	6002 04 04 2/3
25	86,78	6002 05 06 1/3	116,08	6002 05 06 2/3	79,44	6002 05 04 1/3	108,74	6002 05 04 2/3
32	94,03	6002 06 06 1/3	119,00	6002 06 06 2/3	86,90	6002 06 04 1/3	126,13	6002 06 04 2/3
40	99,62	6002 07 06 1/3	133,62	6002 07 06 2/3	91,47	6002 07 04 1/3	125,47	6002 07 04 2/3
50	109,61	6002 08 06 1/3	147,91	6002 08 06 2/3	100,71	6002 08 04 1/3	139,01	6002 08 04 2/3
65	145,70	6002 09 06 1/3	196,90	6002 09 06 2/3				
80	194,12	6002 10 06 1/3	263,52	6002 10 06 2/3	183,00	6002 10 04 1/3	252,40	6002 10 04 2/3
100	270,27	6002 12 06 1/3	367,77	6002 12 06 2/3	257,51	6002 12 04 1/3	355,01	6002 12 04 2/3
125	585,79	6002 13 06 1/3	802,29	6002 13 06 2/3				
150	1085,20	6002 15 06 1/3	1497,50	6002 15 06 2/3	1064,08	6002 15 04 1/3	1476,38	6002 15 04 2/3

Inline Sight Glasses and Accessories

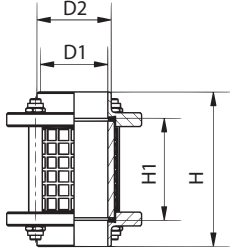

Delivery only with safety screen.

Inline Sight Glass Weld/Weld Inch

DN Inch	D1	D2	H	H1	Weight [kg]
1"	22.1	25.4	96	70	0.72
1 1/2"	34.8	38.1	110	70	1.12
2"	47.5	50.8	110	70	1.38
2 1/2"	60.2	63.5	124	85	1.90
3"	72.9	76.2	132	85	2.35
4"	97.38	101.6	167	115	2.80

Borosilicate Glass Cylinder

DN DIN	DN Inch	D1	D2	H	Max. working pressure (bar)	Weight [kg]
10		10	15	60	10	0.02
15		17	22	60	10	0.02
20		20	26	60	10	0.03
25	1"	26	32	70	10	0.04
32		34	40	70	10	0.06
40	1 1/2"	40	50	70	10	0.11
50	2"	50	60	70	10	0.14
	2 1/2"	60	70	85	10	0.18
65		65	75	85	10	0.21
	3"	75	85	90	9	0.27
80		80	90	85	8	0.30
100	4"	100	110	115	7	0.43
125		126	140	160	7	1.12
150		152	170	170	7	1.80

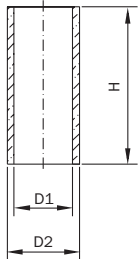

Seal Ring

DN DIN	DN Inch	D1	D3	S
10		11	16	3
15		17	23	3
20		21	27	3
25	1"	27	33	3
32		34	41	3
40	1 1/2"	40	51	3
50	2"	51	61	3
	2 1/2"	60	71	4
65		66	76	4
	3"	75	86	4
80		81	91	4
100	4"	101	111	4
125		127	141	4
150		153	171	4

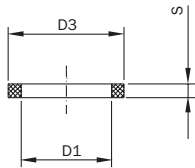

Inline Sight Glasses and Accessories

Inline Sight Glass Weld/Weld Inch

1.4301 (304)/NBR with safety screen perforated plate		1.4404 (316L)/NBR with safety screen perforated plate		1.4301 (304)/NBR with safety screen polycarbonate		1.4404 (316L)/NBR with safety screen polycarbonate		
DN Inch	Price/EUR	Article No.	Price/EUR	Article No.	Price/EUR	Article No.	Price/EUR	Article No.
1"	57,08	6000 54 06 1/3	75,08	6000 54 06 2/3	49,74	6000 54 04 1/3	67,74	6000 54 04 2/3
1 1/2"	64,82	6000 57 06 1/3	84,42	6000 57 06 2/3	56,67	6000 57 04 1/3	76,27	6000 57 04 2/3
2"	69,41	6000 58 06 1/3	91,41	6000 58 06 2/3	60,51	6000 58 04 1/3	82,51	6000 58 04 2/3
2 1/2"	87,40	6000 59 06 1/3	115,30	6000 59 06 2/3				
3"	117,02	6000 60 06 1/3	154,92	6000 60 06 2/3	101,97	6000 60 04 1/3	139,87	6000 60 04 2/3
4"	146,97	6000 62 06 1/3	195,17	6000 62 06 2/3	127,41	6000 62 04 1/3	175,61	6000 62 04 2/3

Borosilicate Glass Cylinder

Borosilicate Glass			
DN DIN	DN Inch	Price/EUR	Article No.
10		4,30	6000 01 03 9
15		4,30	6000 03 03 9
20		5,10	6000 04 03 9
25	1"	5,60	6000 05 03 9
32		6,85	6000 06 03 9
40	1 1/2"	7,05	6000 07 03 9
50	2"	11,00	6000 08 03 9
	2 1/2"	13,40	6000 59 03 9
65		12,15	6000 09 03 9
	3"	19,35	6000 60 03 9
80		22,00	6000 10 03 9
100	4"	41,45	6000 12 03 9
125		92,10	6000 13 03 9
150		133,15	6000 15 03 9

Seal Ring

NBR				EPDM		
DN DIN	DN Inch	Spare part price/EUR	Article No.	Spare part price/EUR	Article No.	Surcharge/EUR
10		0,92	6000 01 05 3	1,15	6000 01 05 1	0,46
15		0,97	6000 03 05 3	1,20	6000 03 05 1	0,46
20		1,00	6000 04 05 3	1,25	6000 04 05 1	0,51
25	1"	1,02	6000 05 05 3	1,28	6000 05 05 1	0,51
32		1,05	6000 06 05 3	1,35	6000 06 05 1	0,61
40	1 1/2"	1,07	6000 07 05 3	1,38	6000 07 05 1	0,61
50	2"	1,12	6000 08 05 3	1,41	6000 08 05 1	0,56
	2 1/2"	1,18	6000 59 05 3	1,48	6000 59 05 1	0,61
65		1,20	6000 09 05 3	1,51	6000 09 05 1	0,61
	3"	1,33	6000 60 05 3	1,56	6000 60 05 1	0,46
80		1,28	6000 10 05 3	1,61	6000 10 05 1	0,66
100	4"	1,35	6000 12 05 3	1,71	6000 12 05 1	0,72
125		5,04	6000 13 05 3	6,29	6000 13 05 1	2,50
150		6,75	6000 15 05 3	8,44	6000 15 05 1	3,37

Inline Sight Glasses and Accessories

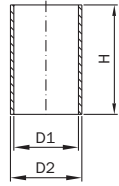

According to risk assessment AWH inline sight glasses are supplied with safety screen.

Safety Screen (Polycarbonate)

DN	DIN	DN Inch	D1	D2	H	Weight [kg]
10			20	24	50	0.01
15			27	30	50	0.01
20			35	38	50	0.01
25		1"	36	40	61	0.01
32			42	45	61	0.02
40		1 1/2"	54	60	61	0.02
50		2"	66	70	61	0.03
80		3"	95	100	77	0.04
100		4"	128	133	103	0.07
150			194	200	158	0.17

Safety Screen (perforated plate)

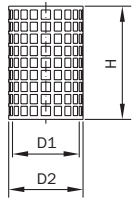

According to risk assessment AWH inline sight glasses are supplied with safety screen.

DN	DIN	DN Inch	D1	D2	H	Weight [kg]
10			19	21	46	0.01
15			25	27	46	0.01
20			29	31	46	0.01
25		1"	34	36	60	0.01
32			41	43	60	0.02
40		1 1/2"	52	54	60	0.02
50		2"	63	65	60	0.03
65		2 1/2"	78	80	74	0.04
80		3"	94	96	74	0.04
100		4"	113	115	102	0.07
125			143	145	144	0.12
150			173	175	158	0.17

Inline Sight Glasses and Accessories

Safety Screen (Polycarbonate)

Polycarbonate			
DN DIN	DN Inch	Price/EUR	Article No.
10		4,04	6000 01 04 9
15		3,94	6000 03 04 9
20		3,94	6000 04 04 9
25	1"	4,04	6000 05 04 9
32		4,50	6000 06 04 9
40	1 1/2"	5,27	6000 07 04 9
50	2"	5,01	6000 08 04 9
80	3"	9,20	6000 10 04 9
100	4"	11,81	6000 12 04 9
150		26,28	6000 15 04 9

Safety Screen (perforated plate)

1.4301 (304)			
DN DIN	DN Inch	Price/EUR	Article No.
10		9,28	6000 01 06 1
15		9,51	6000 03 06 1
20		11,12	6000 04 06 1
25	1"	11,38	6000 05 06 1
32		11,63	6000 06 06 1
40	1 1/2"	13,42	6000 07 06 1
50	2"	13,91	6000 08 06 1
65	2 1/2"	18,10	6000 09 06 1
80	3"	20,32	6000 10 06 1
100	4"	24,57	6000 12 06 1
125		34,79	6000 13 06 1
150		47,40	6000 15 06 1

Sight Glasses and Accessories

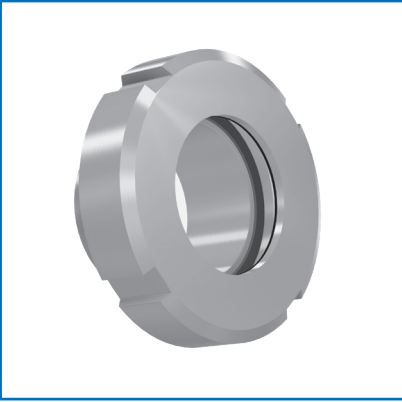

1. In the standard sight glass, a pane of tempered glass is screwed in to a male with a welded end using a seal ring and a grooved nut. The sight glass is made of Borosilicate glass, which offers excellent strength and thermal stability. The maximum temperature is 280 °C (acc. to DIN 7080). The change in temperature from 230 °C to 20 °C must take at least 1 minute.
2. The sight glass with a wiper blade is used for liquids with large amounts of solid particles that can leave deposits on the Borosilicate pane.
3. The light for the sight glass comes in two different versions:
 - For the sight glass unit DIN welding ends. With this version, the medium is transilluminated.
 - For the sight glass DIN welding. In this case, the medium is illuminated.

When properly installed, a protective rating of IP65 in compliance with EN 60529 / DIN VDE 0470 Part 1 (dust tight and protected against low pressure jets of water) is achieved.

The lights are not suited for use in explosion-prone operating environments.

Technical Parameter

Material:	in contact with the product: 1.4301 (304) /1.4307 (304L), 1.4404 (316L) not in contact with the product: 1.4301 (304) /1.4307 (304L) Sight glass: Borosilicate
Surface:	inside: $Ra \leq 0.8 \mu m$ outside: fine turned
Anschlüsse:	standard: welding ends DIN EN 10357

Installation Instructions

When welding the male, ensure that the unit is not deformed during the welding process. This must be done by trained and authorised personnel.

Additional Installation Instructions for the Sight Glass with Light

- The light must be installed by trained, authorised personnel with the voltage specified on the identification plate.
- Sight glass lights have a dedicated purpose and are designed exclusively for the intended application.
- Inline sight glasses with a built-in pushbutton are designed for pushbutton mode only.
- Inline sight glasses intended for continuous operation must be operated using an external switch. This must always be specified in the order.
- The lights are not suitable for explosion-prone operating environments.

Attention: Continuous operation is only permitted for some lights. Please be aware of this when ordering and always specify this in your order!

Additional Installation Instructions for the Sight Glass with Wiper Blade

- The wiper blade may only be used in a temperature range of -40 °C to 140 °C.
- The maximum nominal pressure of the unit is 6 bar.
- The wiper screw must be regularly checked for tightness and re-tightened as necessary.

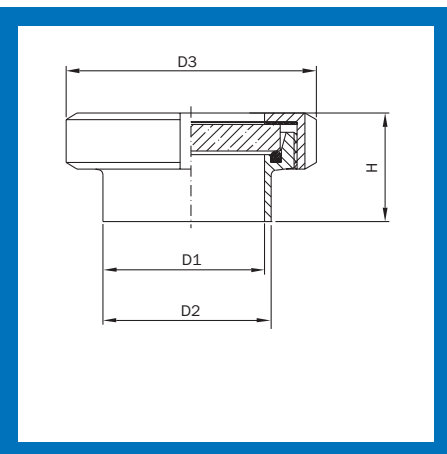

Sight Glass with Borosilicate Glass for Pipe Dimensions acc. to DIN EN 10357

DN DIN	D1	D2	D3	H	Weight [kg]
25	26	29	63	37	0.31
32	32	35	70	40	0.40
40	38	41	78	41	0.48
50	50	53	92	43	0.69
65	66	70	112	48	1.10
80	81	85	127	54	1.61
100	100	104	148	64	2.27
125	125	129	178	58	3.08
150	150	154	210	60	5.28

Explosion View

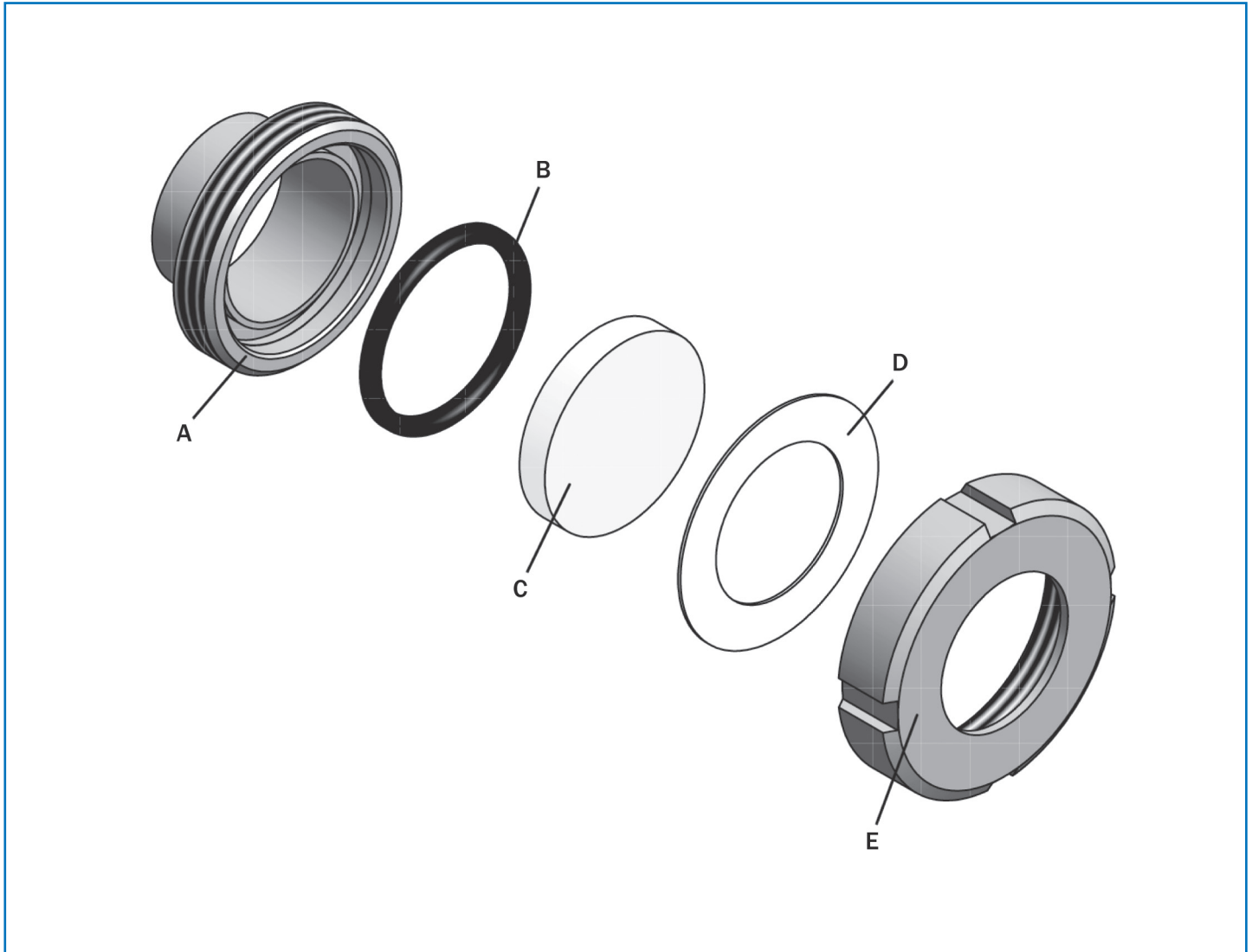

- A** Male
- B** Seal ring
- C** Borosilicate glass
- D** Disc
- E** Nut

Sight Glass with Borosilicate Glass for Pipe Dimensions acc. to DIN EN 10357

1.4301 (304)/NBR		1.4404 (316L)/NBR		
DN DIN	Price/EUR	Article No.	Price/EUR	Article No.
25	37,25	6020 05 00 1/3	53,46	6020 05 00 2/3
32	39,37	6020 06 00 1/3	58,67	6020 06 00 2/3
40	41,64	6020 07 00 1/3	61,30	6020 07 00 2/3
50	44,28	6020 08 00 1/3	67,00	6020 08 00 2/3
65	56,17	6020 09 00 1/3	75,59	6020 09 00 2/3
80	77,26	6020 10 00 1/3	101,36	6020 10 00 2/3
100	104,89	6020 12 00 1/3	131,17	6020 12 00 2/3
125	177,90	6020 13 00 1/3	222,36	6020 13 00 2/3
150	415,73	6020 15 00 1/3	519,68	6020 15 00 2/3

Sight Glasses and Accessories

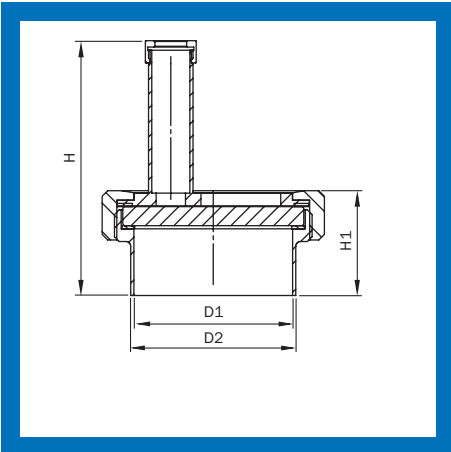

Sight Glass with LED Light, wireless

DN DIN	D1	D2	H	H1	Weight [kg]
65	66	70	145	49.5	1.39
80	81	85	153.5	57.5	1.88
100	100	104	160.5	66	2.33

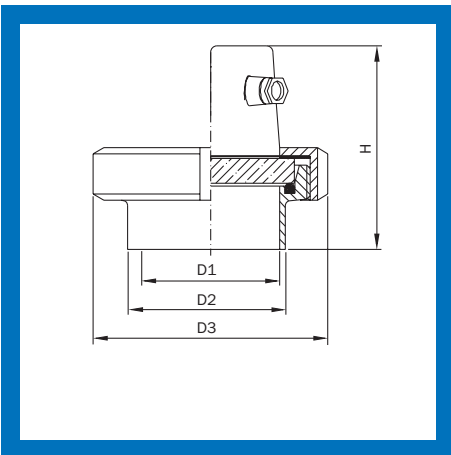

Sight Glass with LED Light, wired

DN DIN	D1	D2	D3	H	Weight [kg]
80	81	85	127	91	2,10
100	100	104	148	100	2,70
125	125	129	178	95	3,60

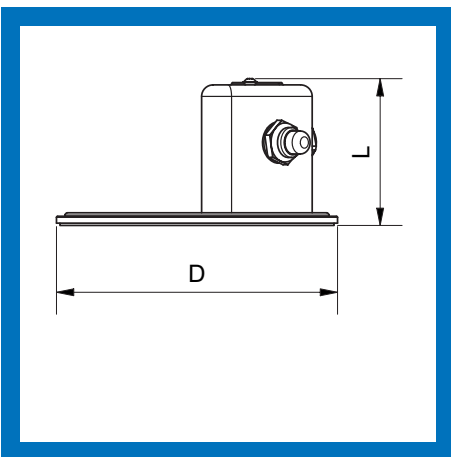

LED Light Housing, wired

DN DIN	D	L	Gew. [kg]
80	101	43	0,45
100	122	45	0,53
125	148	45	0,69

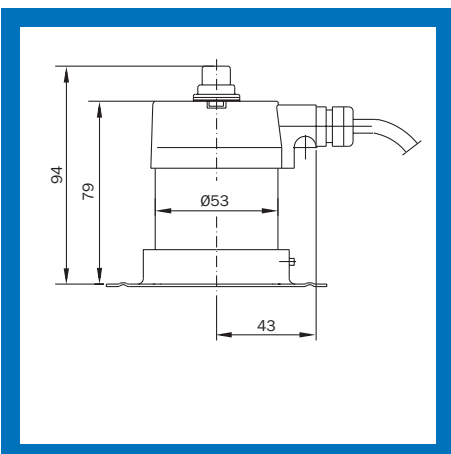

Light for Inline Sight Glass Unit Weld/Weld DIN

DN DIN
65
100

Sight Glasses and Accessories

Sight Glass with LED Light, wireless

1.4301 (304)/Silicone

DN DIN	Price/EUR	Article No.
65	184,60	6031 09 00 1
80	198,40	6031 10 00 1
100	226,20	6031 12 00 1

Protection class: IP65
 Electrical data
 Operating voltage: 1x Mignon battery 1,5V
 Bulb: LED ~80 Lumen

Sight Glass with LED Light, wired

1.4404 (316L)/NBR/LED

DN DIN	Price/EUR	Article No.
80	261,10	603 110 400
100	309,80	603 112 400
125	454,80	603 113 400

Protection class: IP65
 Spare part number for LED: 60314001
 CE Conformity: EMV/RoHS
 Operating voltage: 24 V with pushbutton
 Bulb: LED ~550 Lumen, 4 Watt

LED Light Housing, wired

1.4308 (AISI CF 8)/LED

DN DIN	Preis/EUR	Artikel-Nr.
80	159,70	6031 10 40 1
100	178,60	6031 12 40 1
125	232,40	6031 13 40 1

Protection class: IP65
 Spare part number for LED: 60314001
 CE Conformity: EMV/RoHS
 Operating voltage: 24 V with pushbutton
 Bulb: LED ~550 Lumen, 4 Watt

Light for Inline Sight Glass Unit Weld/Weld DIN

DN DIN	Price/EUR	Article No.
65	307,80	6023 09 00 0
100	307,80	6023 12 00 0

Protection class: IP65
 Operating conditions: max. permissible ambient temperature at the cable entry 55 °C
 Electrical data
 Operating voltage: without installation pushbutton: 24 V halogen incandescent lamp 20 W
 with installation pushbutton: 24 V halogen incandescent lamp 50 W

Sight Glasses and Accessories

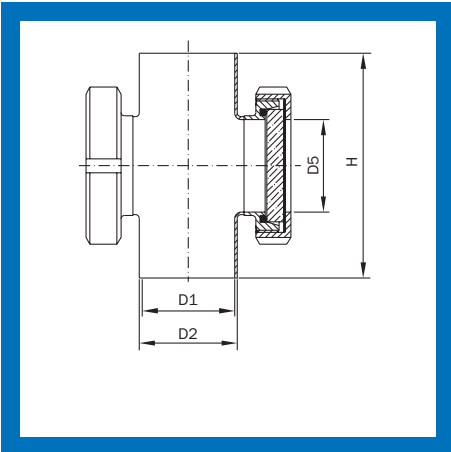

Inline Sight Glass Unit for Pipe Dimensions acc. to DIN EN 10357 Weld/Weld DIN

DN DIN	D1	D2	D5	H	Weight [kg]
25	25	28	26	100	0.85
25	26	29	26	100	0.85
32	31	34	32	110	0.90
32	32	35	32	110	0.90
40	37	40	38	120	1.10
40	38	41	38	120	1.10
50	49	52	50	140	1.50
50	50	53	50	140	1.50
65	66	70	66	160	1.80
80/65	81	85	66	180	2.80
100/65	100	104	66	200	3.00
125/100	125	129	100	375	6.20
150/100	150	154	100	450	6.50

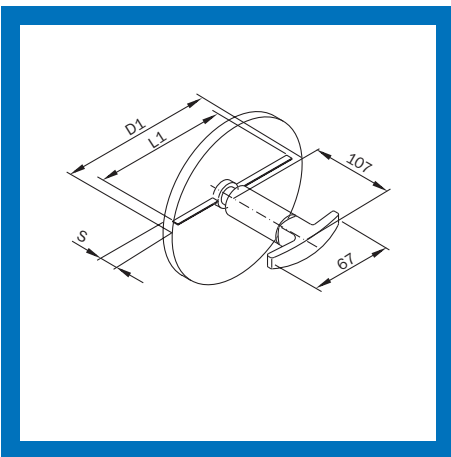

Wiper Blade with Sight Glass Plate

DN DIN	D1	L1	S	Weight [kg]
65	80	63	12	0.20
80	100	77	15	0.48
100	113	97	15	0.53

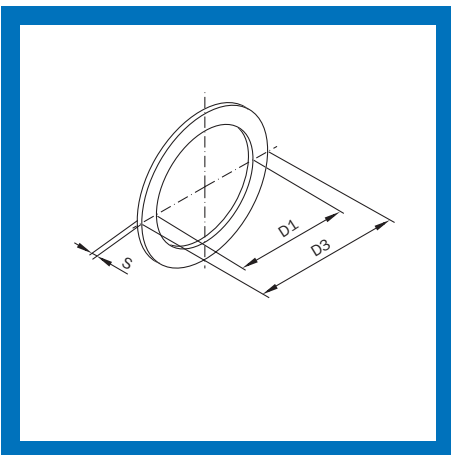

Disc

DN DIN	D1	D3	S	Weight [kg]
25	26	52	1	0.00
32	32	58	1	0.01
40	38	65	1	0.01
50	50	78	1	0.01
65	66	95	1	0.01
80	81	110	1	0.01
100	100	130	1	0.02
125	125	160	1	0.04
150	150	190	1	0.05

Sight Glasses and Accessories

Inline Sight Glass Unit for Pipe Dimensions acc. to DIN EN 10357 Weld/Weld DIN

1.4301 (304)/NBR			1.4404 (316L)/NBR	
DN DIN	Price/EUR	Article No.	Price/EUR	Article No.
25	123,91	6021 05 00 1/3	162,18	6021 05 00 2/3
25	123,91	6021 43 00 1/3	162,18	6021 43 00 2/3
32	129,48	6021 06 00 1/3	171,92	6021 06 00 2/3
32	129,48	6021 44 00 1/3	171,92	6021 44 00 2/3
40	132,50	6021 07 00 1/3	184,99	6021 07 00 2/3
40	132,50	6021 45 00 1/3	184,99	6021 45 00 2/3
50	147,30	6021 08 00 1/3	207,64	6021 08 00 2/3
50	147,30	6021 46 00 1/3	207,64	6021 46 00 2/3
65	157,91	6021 09 00 1/3	221,41	6021 09 00 2/3
80/65	200,22	6021 10 00 1/3	260,07	6021 10 00 2/3
100/65	221,44	6021 12 00 1/3	289,29	6021 12 00 2/3
125/100	422,05	6021 13 00 1/3	*	6021 13 00 2/3
150/100	469,47	6021 15 00 1/3	*	6021 15 00 2/3

Wiper Blade with Sight Glass Plate

DN DIN	Price/EUR	Article No.
65	264,85	6024 09 00
80	286,32	6024 10 00
100	286,32	6024 12 00

For optional manual cleaning of glass plates in inline sight glass units
 Operating conditions: vacuum-tight; pressure-resistant up to at least 2 bar
 6 bar depending on the dimensions of the sight glass plate
 max. permitted temperature: 220 °C
 (depending on the sight glass plate used)

Disc

PTFE		
DN DIN	Price/EUR	Article No.
25	1,41	6020 05 04 4
32	1,92	6020 06 04 4
40	2,20	6020 07 04 4
50	2,51	6020 08 04 4
65	3,37	6020 09 04 4
80	4,14	6020 10 04 4
100	6,77	6020 12 04 4
125	9,66	6020 13 04 4
150	10,48	6020 15 04 4

Sight Glasses and Accessories

Borosilicate Glass

DN DIN	D2	S	Weight [kg]
25	45	10	0.03
32	50	10	0.04
40	55	10	0.06
50	63	10	0.08
65	80	12	0.14
80	100	15	0.29
100	117	15	0.33
125	150	20	0.66
150	175	20	1.18

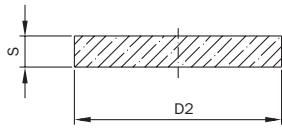

Borosilicate Glass for LED Sight Glass, wireless

DN DIN	D2	S	Weight [kg]
65	80	10	0,15
80	95	10	0,25
100	114	12	0,28

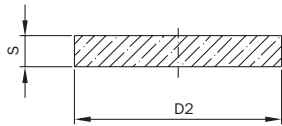

Nut for Sight Glass

DN	B1	B2	D1	D3	E	Weight [kg]
25	21	18	26	63	Rd 52 x 1/6"	0.18
32	21	18	32	70	Rd 58 x 1/6"	0.22
40	21	18	38	78	Rd 65 x 1/6"	0.25
50	22	19	50	92	Rd 78 x 1/6"	0.33
65	25	21	66	112	Rd 95 x 1/6"	0.55
80	29	25	81	127	Rd 110 x 1/4"	0.80
100	31	26	100	148	Rd 130 x 1/4"	1.08
125	35	30	125	178	Rd 160 x 1/4"	1.45
150	40	34	150	210	Rd 190 x 1/4"	1.88

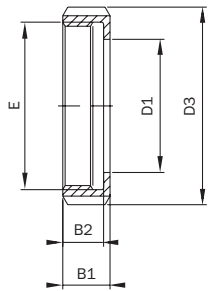

Sight Glasses and Accessories

Borosilicate Glass

Borosilicate Glass		
DN DIN	Price/EUR	Article No.
25	15,52	6020 05 03 9
32	16,16	6020 06 03 9
40	19,35	6020 07 03 9
50	24,03	6020 08 03 9
65	32,26	6020 09 03 9
80	35,25	6020 10 03 9
100	55,91	6020 12 03 9
125	64,78	6020 13 03 9
150	91,65	6020 15 03 9

Borosilicate Glass for LED Sight Glass, wireless

Borosilicate Glass		
DN DIN	Price/EUR	Article No.
65	33,50	6031 09 03 9
80	36,25	6031 10 03 9
100	56,70	6031 12 03 9

Nut for Sight Glass

1.4301 (304)/pol		1.4404 (316L)/pol		
DN	Price/EUR	Article No.	Price/EUR	Article No.
25	12,25	60015 000 025 10	15,10	60015 000 025 30
32	12,80	60015 000 032 10	15,80	60015 000 032 30
40	13,10	60015 000 040 10	16,00	60015 000 040 30
50	14,00	60015 000 050 10	20,00	60015 000 050 30
65	19,55	60015 000 065 10	27,00	60015 000 065 30
80	28,00	60015 000 080 10	34,15	60015 000 080 30
100	39,15	60015 000 100 10	56,55	60015 000 100 30
125	67,85	60015 000 125 10	120,35	60015 000 125 30
150	226,38	60015 000 150 10	287,25	60015 000 150 30

20 Level Indicator

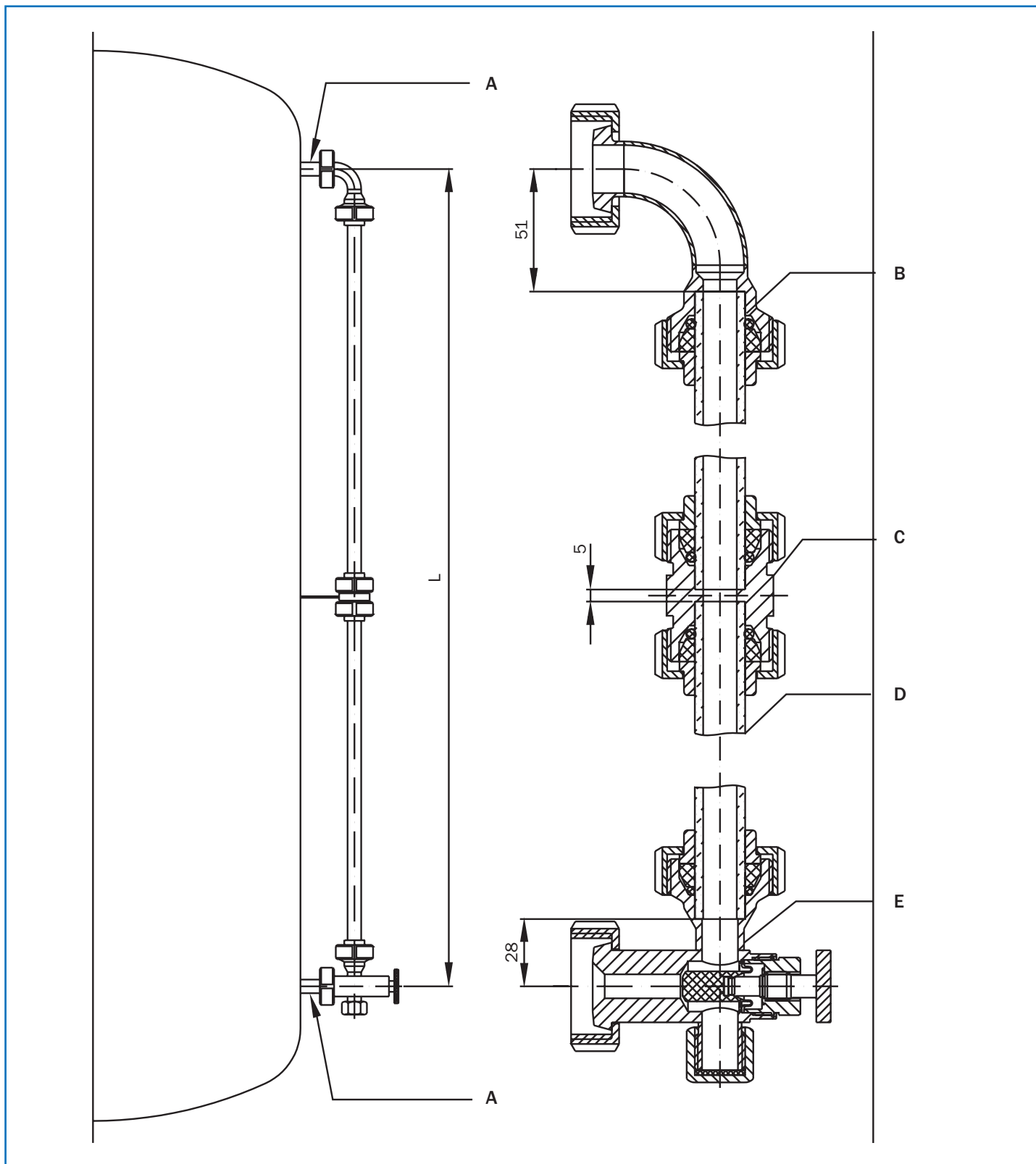

- A** Male DN20
- B** Upper part
- C** Coupling
- D** Glass tube
- E** Valve

A coupling has to be used for level indicator lengths over 3000 mm.

Level Indicator

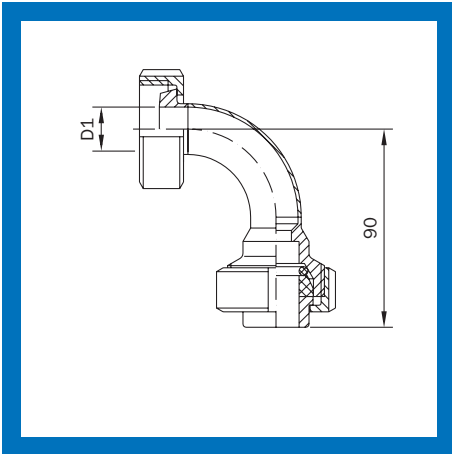

Upper Part for Level Indicator

DN DIN	D1	1.4404 (316L)	
		Price/EUR	Article No.
20	20	181,30	6310 04 00 2

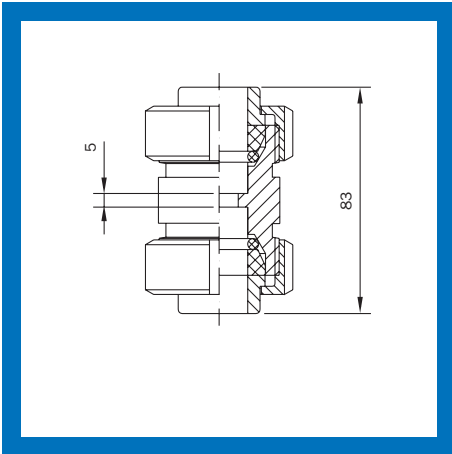

Coupling for Level Indicator

DN DIN	1.4404 (316L)	
	Price/EUR	Article No.
20	156,65	6320 04 00 2

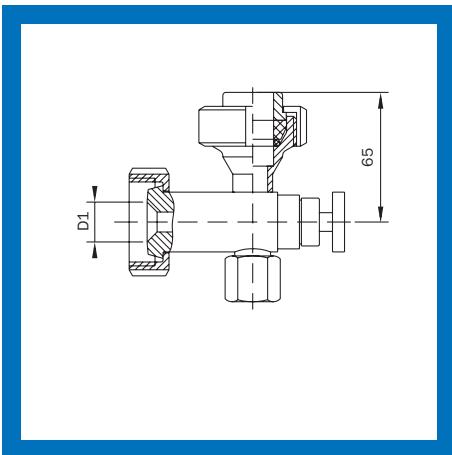

Valve for Level Indicator

DN DIN	DN Inch	D1	Description	1.4404 (316L)	
				Price/EUR	Article No.
20		20	with DN10 male and cover cap	326,30	6330 04 00 2
	1/2"		with G 1/2" connecting nipple and cover cap	323,15	6331 04 00 2
	1/2"		Drain cock	85,03	50019 000 012 34
	1/2"		Ball cock	9,63	4601 52 00 2

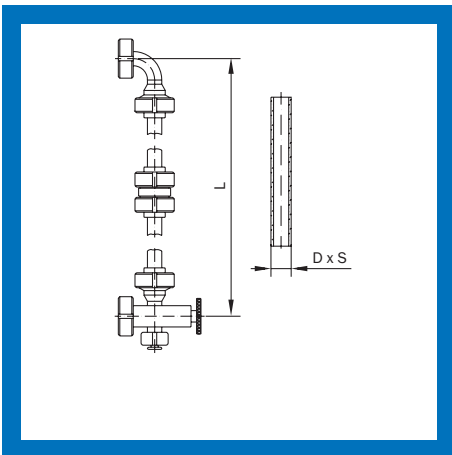

Glass Tube for Level Indicator

L	D x S	1.4404 (316L)	
		Price/EUR	Article No.
Specify in order	20 x 2.5	*	60005 000 020 66

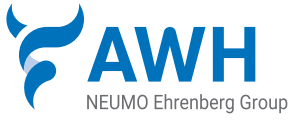

Armaturenwerk Hötensleben GmbH
 Schulstr. 5-6
 D-39393 Hötensleben

Tel: +49 39405 92-0
 Fax: +49 39405 92-111
 E-Mail: info@awh.eu
 http://www.awh.eu

NEUMO Ehrenberg Group

